

CRI 31
Crime Scene Report
Team 1

CRI-31

REPORT DATE October 3, 1999	COLORADO BUREAU OF INVESTIGATION REPORT OF INVESTIGATION	FILE P99-0453 D99-1333
TYPE OF REPORT Crime Scene	REPORT BY Agent Barie W. Goetz, Team Leader	AREA Jefferson County
NATURE OF CASE Homicide		

CRIME SCENE REPORT FOR TEAM ONE

REQUESTING AGENCY: Jefferson County Sheriff's Office, 200 Jefferson County Parkway, Golden, CO 80401, 303-271-5600

REQUESTING OFFICER: Lab Supervisor Chris Andrist

INVESTIGATING OFFICER: Lab Supervisor Chris Andrist

DATE OF REQUEST: April 20, 1999

DATE OF OFFENSE: April 20, 1999

AGENCY CASE NUMBER: 99-7625

LOCATION OF SCENE: Columbine High School, 6201 South Pierce, Jefferson County Colorado

VICTIMS: Lauren Townsend DOB: (011781)
(Deceased) Kelly Fleming DOB: (010683)
John Tomlin DOB: (090182)
Corey Depooter DOB: (030382)
Daniel Mauser DOB: (062583)

SUSPECTS: Dylan Klebold DOB: (091181)
Eric Harris DOB: (040981)

WEATHER CONDITIONS: Varied

EVIDENCE SEIZED BY: Chris Loptien, Jefferson County Sheriff's Office

EVIDENCE IN CUSTODY OF: Jefferson County Sheriff's Office

Type of Report Crime Scene	Agent Barie W. Goetz	Date 10/03/99	File Number P99-0453 D99-1333	Page 2
-------------------------------	-------------------------	------------------	-------------------------------------	-----------

REMARKS:

On April 20, 1999, crime scene personnel from various law enforcement agencies were assigned to assist with the processing of a crime scene at Columbine High School, located in Jefferson County, Colorado.

Upon arrival at the Command Post located on Pierce Street by Clement Park, crime scene personnel were informed that the bomb squads of various agencies were in the process of clearing the school and the parking lot of explosive devices. At approximately 11:30 p.m., all crime scene personnel were instructed that processing of the scene would not start until the bomb squads had completed their activities; therefore, all crime scene personnel would report back to the command post on Wednesday, April 21, 1999 at 8:00 a.m.

ACTION TAKEN:

At 11:45 a.m. on April 21, 1999, Chris Andrist of the Jefferson County Sheriff's Office conducted a briefing for crime scene personnel. A plan was presented to divide the crime scene into specific areas and assign a team of four or five crime scene personnel to each area. A team leader was designated for each team.

Team One personnel consisted of :

Barie Goetz, Colorado Bureau of Investigation
Ted Ritter, Colorado Bureau of Investigation
Tom Adair, Arapahoe County Sheriff's Office
Chris Loptien, Jefferson County Sheriff's Office
Donald Sollars, Colorado Bureau of Investigation

Team One was assigned the eastern half of the school library, which included victims numbered 1 through 5. In addition, Team One was later assigned the northwest library offices, hallway and the emergency exit door in that area.

At approximately 1:39 p.m., April 21, 1999, members of Team One were escorted through the crime scene portion of the school for orientation purposes. At approximately 2:05 p.m., team members initiated processing of the school library. The main emphasis of processing for the day was evidence documentation and collection to facilitate body recovery.

Type of Report Crime Scene	Agent Barie W. Goetz	Date 10/03/99	File Number P99-0453 D99-1333	Page 3
-------------------------------	-------------------------	------------------	-------------------------------------	-----------

Duties assignments of Team One were:

Barie Goetz - bloodstain pattern interpretation, coordinator of the team.

Ted Ritter - photography, firearm evidence recognition

Tom Adair - measurements, crime scene sketching

Chris Loptien - evidence collection, evidence log

Donald Sollars - photography log

All team members were assigned the task of evidence recognition and the marking of its location with a green placard evidence marker. Numbers 600 through 899 were assigned to Team One for identifying evidence.

The main part of the school library consisted of an entryway on the northeast, staff counter and workspace on the north, student study areas with tables and chairs on the south, and computer tables on the northwest. Secondary areas of the library consisted of storage and staff rooms to the north of the main library and offices and hallway in the northwest area. The student study area was physically divided into three sections by the placement of bookshelves oriented north-to-south. Bookshelf Row 1 was attached to the east wall. Rows 2, 3, and 4 separated the east student section from the middle student section. Rows 5 and 6 separated the middle section from the southwest section. The east section of the student study area consisted of six tables, labeled Table 1 through Table 6 with accompanying chairs labeled 1A, 1B, etc. Three of the victims, #1, #2 and #3, were located in this section. The middle section of the student area consisted of eight tables, labeled Table 7 through Table 14, with accompanying chairs labeled 7A, 7B, etc. Two of the victims, #4 and #5, were located in this middle section. The west section was designated as part of the area processed by Team Two and its description is included in their report.

The Federal Bureau of Investigation Special Projects Team was present to prepare a detailed diagram of the entire school and surrounding areas. The Arapahoe County Sheriff's Office representatives on Teams One and Two have generated a detailed diagram of the library with the location of all physical features of the area and all items of evidence. Therefore, measurements concerning the location of evidence, bullet holes, tables, chairs, walls, windows, desks, etc. will not be included in the narrative of this report.

Type of Report Crime Scene	Agent Barie W. Goetz	Date 10/03/99	File Number P99-0453 D99-1333	Page 4
-------------------------------	-------------------------	------------------	-------------------------------------	-----------

All items of evidence were assigned a number, photographed in place, measured for final location in sketch, and then collected in a suitable container and marked with the case number, item number, date, time, location, description, and the initials of the collector. The Jefferson County Sheriff's Office has generated a detailed list of evidence for the entire school and area; therefore, a detailed list of the evidence collected by Team One is not included in the narrative of this report.

Prior to collection of evidence, overall photographs were taken of the library entrance, main staff counter, student area, and bodies of the deceased.

Processing was initiated in the entryway. Evidence items consisting of spent cartridge cases and firearm projectiles were located and collected from this area. The entryway was then utilized as a staging area for equipment and personnel.

The area leading up to Table 2 in the east section of the student study area was processed for obvious items of evidence. Apparent bullet holes were present in the carpet under and surrounding Table 2.

Victim #1, later identified as LAUREN TOWNSEND, was found lying on her left side, bent at the waist, head to the north, feet to the east, under the northwest corner of the table. She was dressed in a blue top, denim pants and dark boots. Multiple bullet holes were noted in the back of the shirt. Bloodstains associated with the upper two holes were consistent with drainage of blood while the body was positioned as found. Minimal drainage was present around the two lower holes. Concentrated drainage of blood was present under the left arm. A linear blood drainage stain was present in the rectal area. Bullet holes were present in the right thigh area with surrounding blood drainage stains consistent with the position of the body as found. Transfer bloodstains were present on the lower legs and on the sides and bottom of the boots. These bloodstains were not associated with injuries to the victim. Bloodstains on the carpet indicated that the legs of the victim were moved to the east through wet bloodstains to their position as found. The position of Table 2 and the surrounding chairs were marked on the carpet and then moved to view the body. Additional bullet holes were noted in the front crotch area when the body

Type of Report Crime Scene	Agent Barie W. Goetz	Date 10/03/99	File Number P99-0453 D99-1333	Page 5
-------------------------------	-------------------------	------------------	-------------------------------------	-----------

was moved. Photographs were taken of the position of the body, the bloodstains present on the body, and the bloodstains on the carpet surrounding the victim. A bloodstained shirt was present under Table 2 to the south of victim #1. Medical treatment type packages and bandages were present in this area. Bloodstain patterns on the carpet and on the vertical supports of Table 2 along with the shirt and bandages indicated that multiple injured individuals were present at some time under the table and then moved from the scene.

Victim #2, later identified as KELLY FLEMING, was found lying on the floor in a prone position to the southeast of Table 2. She was dressed in a black shirt, denim pants and black/white tennis shoes. An entry wound consistent with a shotgun discharge was present in the lower left back of the body. The plastic shotgun cup/wad was present in the wound tract. Several associated pellet holes were present adjacent to the main entry wound. Drainage of blood from the wound was minimal and consistent with the position of the body as found. Drainage of blood from the nose/mouth area was consistent with the position of the body as found. No other bloodstains were present on the body. Photographs were taken of the position of the body, the bloodstains present on the body, and the bloodstains on the carpet surrounding the body.

Victim #3, later identified as JOHN TOMLIN, was found lying on the floor in a prone position to the southeast of Table 6. He was dressed in a dark T-shirt, denim pants, and white/black tennis shoes. Numerous wood fragments and pieces of foam padding were dispersed in the area of the body. Drainage of blood from the right side of the head was consistent with the position of the body as found. A large pool of blood was present on the carpet extending to the west of the victim's head area and under the victim's chest and right arm. The victim's eyeglasses were present under the lower portion of the face. No bloodstains were noted on the pants or shoes of the victim. No impact blood spatter was noted in the area. Photographs were taken of the position of the body, the bloodstains present on the body, and the bloodstains on the carpet surrounding the body.

Type of Report Crime Scene	Agent Barie W. Goetz	Date 10/03/99	File Number P99-0453 D99-1333	Page 6
-------------------------------	-------------------------	------------------	-------------------------------------	-----------

Victim #4, later identified as COREY DEPOOTER, was found lying on the floor in a prone position to the west of Table 14. He was dressed in a gray shirt, denim pants, and brown leather boots. A large concentrated bloodstain consistent with drainage from the rear of the neck and the upper chest was found under the body. This pooling of blood continued onto the carpet to the west of the body. A large concentrated transfer bloodstain was present on the lower back area of the clothing and body. No wounds were present in this area of the body. The bloodstain originated on the exterior of the outer shirt, soaked through to the thermal undershirt and onto the skin of the victim. A strap from the victim's backpack was present under the left arm of the victim and the backpack was found to the west of the body. The bottom of the backpack was heavily blood soaked. No corresponding stain was present on the carpet under the position of the backpack as found. A pattern in the pooled blood to the west of the body was consistent with the size and shape of the backpack bottom. The bloodstain patterns were consistent with the backpack initially lying in the pool of blood from the victim; the backpack being moved to the small of the back of the victim; and then moved to the floor to the west of the body. Photographs were taken of the position of the body, the bloodstains present on the body, and the bloodstains on the carpet surrounding the body.

Victim #5, later identified as DANIEL MAUSER, was found lying on his right side under Table 9 in the middle section. He was dressed in a tan shirt, denim pants, and black/gray tennis shoes. His right arm extended to the south and the wrist area was positioned on top of the right rear stile of Chair 9E. The chair was found lying on its back to the south of the victim. An injury to the fingers of the right hand was present and a small pool of dripped blood was found under the position of the hand. A concentrated pool of blood was present under the head, neck and shoulder area of the victim. Eyeglasses were found under the head of the victim, partially on the upper face. Chair 9E had a bullet path through the chair, entry in the seat cushion and exit in the front upper wooden rail. Wood fragments were dispersed over the body. A number of wood fragments were embedded into the right forearm of the victim. An injury to the right ear was noted upon repositioning of the body prior to transport.

Type of Report Crime Scene	Agent Barie W. Goetz	Date 10/03/99	File Number P99-0453 D99-1333	Page 7
-------------------------------	-------------------------	------------------	-------------------------------------	-----------

Photographs were taken of the position of the body, the position of the chair as found, the bloodstains present on the body, and the bloodstains on the carpet surrounding the body.

Removal of bodies by coroner investigators from various agencies commenced at approximately 5:30 p.m. and was completed by 9:06 p.m.

On Thursday, Friday, Monday, Tuesday and Wednesday, April 22, 23, 26, 27 and 28, 1999 respectively, members of Team One returned to the library to continue documenting and collecting evidence. On Wednesday, April 28, 1999, Dr. Bodelson, Jefferson County Coroner, and the five pathologists who conducted the autopsies, Dr. Michael Dobersen, Dr. Ben Galloway, Dr. Thomas Henry, Dr. John Meyer and Dr. Jim Wahe, briefed the members of Team One on the preliminary results of the autopsies. Their findings are included in the narrative part of this report as they pertain to each victim.

The students' backpacks were examined for items to demonstrate the ownership. Materials remaining on the tables were similarly examined. After verification of the owner by identification cards or a multiple of other items, the student's name was printed on a section of tape and affixed to the table in the approximate location as his/her belongings were found. Backpacks and other items identified as belonging to one of the deceased victims were collected as items of evidence. The film was removed from a camera (item #737) found on top of Table 3 and collected as evidence. A disposable type camera from the top of a table in the middle student study area was collected as evidence.

Table 1, the first table on the right as the east section is viewed from the entryway, contained materials belonging to Mark Kintgen on the southwest corner and Jen Doyle on the northeast corner. Reports listed Mark Kintgen as having gunshot injuries to the head and neck. A pool of blood and eyeglasses were located under the southwest corner of Table 1. Chair 1A was located across from the table position of Kintgen's belongings. It was found facing south and positioned almost all the way under the table. It contained a shotgun discharge hole in the backrest with the entry on the north side and exit on the south side; pellet holes were present in the seat portion. A blood

Type of Report Crime Scene	Agent Barie W. Goetz	Date 10/03/99	File Number P99-0453 D99-1333	Page 8
-------------------------------	-------------------------	------------------	-------------------------------------	-----------

transfer was found on the cross brace (stretcher) of the chair above the blood pool. The longitudinal cross brace under the table directly in front of Chair 1A contained shotgun pellet damage and one pellet was imbedded in this area. Chair 1E was located to the east of Kintgen's belongings and it contained a bullet strike in the southwest leg. Chair 1F was located to the south of Kintgen's belongings on Table 1 and it contained bullet strikes to the rear upper rail and the right rear leg. A blood transfer was present across the top of the backrest of Chair 1F. A bullet strike was found on the exterior surface of the north support of Table 3. No other projectile strike marks were found on Table 3. Trajectory of the shotgun blast to the backrest of Chair 1A aligned with the damage to the seat cushion, cross member of the table, bullet damage to opposing chairs and the eyeglasses and bloodstain under the table.

Preliminary autopsy results from Dr. Dobersen on LAUREN TOWNSEND indicated that both shotgun pellets and 9mm bullets were recovered. The numerous wounds and their locations indicated that the body had been shot in more than one position. Several rounds had exited the body.

Autopsy results from Dr. Dobersen on KELLY FLEMING indicated a single shotgun blast entered the lower left back, traveled straight upward, and the pellets were contained in the upper left back area. The acute angle of travel through the body indicated that the victim was in a prone or near prone position when shot.

Concentrated, congealed bloodstains were found projected onto the exterior vertical surface of the east support of Table 1. The stains range from 29" to 6" from the floor. Chair 1C also contained a concentrated, congealed, projected bloodstain on the left middle rail, 8.5" from the floor. The table support and left side of the chair were exposed to the area under Table 2.

The area under and surrounding Table 2 contained numerous bloodstain patterns. Concentrated pooling of blood was found on the carpet in the southeast area under the head of FLEMING. A large transfer bloodstain was found on the interior surface of the south table support. This stain covered an area 11" high by 12" wide. A concentrated bloodstain was found on the carpet

Type of Report Crime Scene	Agent Barie W. Goetz	Date 10/03/99	File Number P99-0453 D99-1333	Page 9
-------------------------------	-------------------------	------------------	-------------------------------------	-----------

directly below this stain. Concentrated pooling of blood was found on the carpet to the north of this area. Concentrated pooling, dripping, and transfer bloodstains were found on the carpet to the southwest of Table 2. A bloodstained shirt and emergency medical supplies were found to the north of this area. Concentrated pooling of blood with associated spatter was found on the carpet at the base of the north support of Table 3. No bloodstains were found on the remainder of Table 3. Concentrated pooling, dripping, and transfer bloodstains were found on the carpet to the northeast of the table. A drip pattern extended to the north of the table. The bloodstain patterns associated with Table 2 were in excess of what would be expected from the injuries to TOWNSEND and FLEMING. Patterns indicated that individuals were injured under Table 2 and then were transported or moved away from the area. Personal belongings of Jessica Lea Holliday, Lisa Michelle Kreutz, and Jeanna Park were found on the east side of the table. Personal belongings of Diwata Perez and LAUREN TOWNSEND were found on the west side. Personal belongings of Val Schnurr and possibly from a Susan Peters were present on a small table to the northeast of Table 2. Personal belongings of Heather Jackson and Patti Blair were found on Table 3.

Chairs 2A and 2B were found to the north of Table 2. Chair 2A was facing to the northwest; Chair 2B was facing to the southeast. 2A had two bullet entry holes in the seat cushion, one exited the bottom of the chair, and the other one exited the top rail on the right side. Bloodspatter was present on the chair; however, no corresponding patterns were present in the surrounding area. Wood splinters from the chair were found under Table 2. Chair 2B had blood smears on the lower front left leg and on the seat cushion; however, no corresponding patterns were present in the surrounding area. A bullet impact site was present on the rear right leg. The physical evidence found on the chairs indicated that they were originally positioned to the sides of Table 2 and then moved to the positions as found.

Pellet impact sites were present on the interior surface of the north support of Table 2. One pellet penetrated the veneer surface and projected a section of wood from the exterior surface onto the carpet north of the table. This pellet was imbedded in the wood. The trajectory of the pellets indicated that the pellets originated from the

Type of Report Crime Scene	Agent Barie W. Goetz	Date 10/03/99	File Number P99-0453 D99-1333	Page 10
-------------------------------	-------------------------	------------------	-------------------------------------	------------

southeast and traveled under the table and struck the interior of the north support. Pellet wounds to TOWNSEND corresponded with this trajectory. Bullet impact sites in the carpet under and around the table were aligned both north-south and east-west. Examination of the exterior surface of the south support of Table 2 did not reveal any bullet strike marks or bloodstains.

Personal items identified as FLEMING's were found on and under the northeast corner of Table 4. The corresponding chair was moved back from the table. Examination of Table 4 and the six chairs associated with it did not reveal any bloodstains or bullet impact sites. No other person's belongings were found on Table 4.

The north end of Table 6 contained a bloodstain pattern consistent with expired/aspirated blood. The origin of the bloodstains was determined to be approximately 51" above the surface of the floor, 43" from the east baseboard, and 19'6" from the south wall. The north side of Chair 6B also contained fine droplets of blood consistent with the source of bloodstains on Table 6. A linear pattern of small blood droplets was also found on the surface of Table 5 leading up to the position of a bloodstained multifunction tool. The tool was configured into the pliers position. No other bloodstains were found on Tables 5 and 6. Personal belongings of Nicole Nowlen were found on Table 5. Personal belongings of TOMLIN were found on Table 6.

The carpeted area to the southeast of Table 6 contained four bullet impact sites. The trajectories were parallel and were aligned in an east-west orientation consistent with an origin south of Table 5. A jacketed bullet was recovered from one of the carpet strike points. The lower left side of Chair 6D contained two bullet impact sites. The east bookshelf baseboard trim behind Chair 6D also contained a bullet strike. A dowel rod was inserted through the holes in the chair and aligned with the impact site on the baseboard. The convex mirror positioned on a support on the south wall contained a single bullet hole through the mirror and into the wall. A dowel rod was inserted through the mirror holes and into the wall hole to approximate the trajectory. The trajectories of the bullet paths through the mirror and the bullet hole through Chair 6D intersected at a location south of Table 5. Agent

Type of Report Crime Scene	Agent Barie W. Goetz	Date 10/03/99	File Number P99-0453 D99-1333	Page 11
-------------------------------	-------------------------	------------------	-------------------------------------	------------

Goetz held a dowel rod in each hand and approximated the intersection of the trajectories to demonstrate a possible common origin. This area was 9' from the south wall and 14' from the east baseboard. Photographs were taken of the damage to the mirror, baseboard, carpet, Chair 6D, and of the dowel rod trajectories.

Chair 5G contained a shotgun blast through the backrest portion. The entrance was to the rear of the seat back. Additional damage was noted on the upper portion of the front left leg. Debris from the chair was found under and to the east and south of Table 6. Pellets were found to the east of Table 6. Chairs 6A and 6E also contained impact sites. The evidence was consistent with Chair 5G being originally positioned along the west side of Table 6 when a shotgun blast originated from the area north of Table 5. A dowel rod was inserted through the hole to approximate the trajectory. Photographs were taken of the damage, indicated original position, and dowel rod trajectory. As reported above, TOMLIN was found on the floor to the east of Table 6. Preliminary autopsy results by Dr. Thomas Henry indicated three projectiles had entered the right side of the head/neck area and exited the left side. Additional injuries to the torso were consistent with shotgun pellets.

As reported above, MAUSER was found lying under Table 9 in the middle student section with Chair 9E lying to his south. Preliminary autopsy results from Dr. Galloway indicated three wounds. The right hand had two defects present. A bullet graze injury was present on the right ear, and the fatal injury was due to a single bullet that entered the nose and exited the back. Bloodstains on the carpet between Table 1 of the east section and the location of MAUSER indicated an individual with a bleeding injury or injuries traveled from the area of Table 1 toward the west and Table 9. Bloodstains on the rows of bookshelves in this area were found where a person with an injury to the right hand would have touched as he or she moved to the west. The arrangement of chairs to the south of Table 1 indicated an individual in addition to Mark Kington was seated on the south side of Table 1.

A dowel rod was used to demonstrate the trajectory of the bullet hole through Chair 9E. The chair was originally found lying on its back; however, the trajectory through the chair was not feasible with that position. With the

Type of Report Crime Scene	Agent Barie W. Goetz	Date 10/03/99	File Number P99-0453 D99-1333	Page 12
-------------------------------	-------------------------	------------------	-------------------------------------	------------

chair upright on its legs and placed to the south of Table 9, the trajectory of the bullet and a bullet strike mark in the carpet indicated a common area of origin. Photographs were taken of Agent Goetz standing in various locations south of Table 9 holding a dowel rod to simulate a weapon.

As reported above, DEPOOTER was found under Table 14. Preliminary autopsy results from Dr. Jim Wahe indicated three injuries. A single bullet entered the left arm, continued through and entered the left chest, and exited the back of the neck. A second single bullet entered the upper back leaving an atypical entrance hole and lodged in the left chest. A third single bullet entered the back and lodged in the left chest. Three bullet strike marks were found in the carpet under Table 14. Two were aligned east-to-west and one was aligned south-to-north.

Bloodstains were collected from various areas for possible future comparison to injured or deceased individuals. A sample of the pooled bloodstain from under the east end of Table 1 was collected for comparison to the blood of KINGTON. A sample of the bloodspatter from the top of Table 6 and a sample of the droplets from the top of Table 5 were collected for comparison to the bloods of HARRIS and KLEBOLD. Samples of five different bloodstains from the carpet in the area of Table 2 and a sample of the blood from the side of Table 1 were collected for comparison to blood standards of TOWNSEND, FLEMING and the injured individuals who were shot while under Table 2. A sample of the blood from the carpet between bookshelf Rows 2 & 3 and a sample of the transfer stain on a vertical surface of bookshelf Row 4 were collected for comparison to the blood standard of MAUSER. Samples of the pooled blood from under the positions of victims TOWNSEND, FLEMING, TOMLIN, DEPOOTER, and MAUSER were collected as substitute standards of the victims' bloods.

Paper debris was present in the middle student section at the base of bookshelf Row 5. The color and texture of the paper pieces matched the large debris field found between Rows 5 and 6.

A bullet hole was found in the south wall above the third window from the east. A large caliber projectile was collected from this location. The apparent general

Type of Report Crime Scene	Agent Barie W. Goetz	Date 10/03/99	File Number P99-0453 D99-1333	Page 13
-------------------------------	-------------------------	------------------	-------------------------------------	------------

trajectory was consistent with having originated from the window area of the west wall of the library.

An exit bullet hole through an art display on the east wall of the student section was determined to be a continuation of an entrance bullet hole in the west wall of the hallway outside the library. The bullet continued upward into the ceiling of the east section of the library where it ricocheted off of the concrete roof supports and came to rest on the upper surface of the ceiling tile above Table 14. The trajectory of the various paths through the wall and ceiling indicated an origin on the stairs landing leading to the cafeteria.

The center student study section contained eight tables numbered 7 through 14 as depicted on the crime scene diagram. Table 7, the first table on the left as viewed from the north, contained personal belongings of Aaron Welsh. Table 8, the first table on the right as viewed from the north, contained personal belongings of Aaron Cohn, Byron Kirkland, Joshua Lapp, Megan Coxey, Craig Scott, and Brittany Bollerud. A backpack belonging to MAUSER was found on the floor next to Table 9. Table 10 contained personal belongings of Sara Houy and Crystal Woodman. Table 11 contained belongings of John Savage. Table 12 contained personal belongings of Lindsay Elmore and Rebecca Parker. Table 13 contained belongings of Athena Lagos. Table 14 contained belongings of Peter Ball and DEPOOTER. A backpack with items labeled Austin Eubanks was found on a chair along the south wall.

On April 22, 1999 Team One was assigned to process and document the hallway, five offices, conference room, and emergency exit of the northwest corner of the library, as well as the staff service area at the north end of the main library. The area was documented through sketches. Placards were mounted to the walls outside each office designating the offices as "LMC-1", "LMC-2", "LMC-3", "LMC-4", and "LMC-5". The rest of the area was comprised of a conference room, designated as Office #2 in photographs, and a hallway. The following observations were made in each room or hallway. See sketch for measurements of items and bullet holes. Bullet holes were given an alphanumeric designation (for example, BH-1). All entry doors were on the east side of each office.

Type of Report Crime Scene	Agent Barie W. Goetz	Date 10/03/99	File Number P99-0453 D99-1333	Page 14
-------------------------------	-------------------------	------------------	-------------------------------------	------------

LMC-1 was the southernmost office. The office door was closed and locked upon arrival on scene. The office had a long desk that ran the length of the south and west walls. Bookshelves took up much of the space on the north wall. There were windows on the south and west walls of the office. No evidence was located in office LMC-1.

LMC-2 was directly north of LMC-1 and had two windows along the west wall. The office door was closed and locked upon arrival on scene. A rectangular wooden table and four chairs were in the center of the room. A small computer table was against the east wall to the south of the office entry door. A small book cart on casters was against the north wall just west of the entry. There was no evidence located in LMC-2.

LMC-3 was directly north of LMC-2 and had one window along the west wall. The office door was closed and locked upon arrival on scene. A long worktable was attached to the south wall. A chair and a file cabinet were located in the southwest corner of the room. A row of staggered bookshelves was attached to the north wall west of the entry door. An apparent bullet impact defect was observed in the north wall above the door. A bullet fragment (item #763) was recovered from that location (corresponded to BH-6 in LMC-4).

LMC-4 was directly north of LMC-3 and had one window on the west wall. A small table with a television on it was located in the northwest corner of the office. There was a rectangular wooden conference table and six chairs in the center of the room. There was loose wallboard debris over the top of the table. The debris appeared to have come from three bullets that penetrated the north wall of the office, passed over the table, and entered the south wall of the office. The south wall of the office contained three bullet holes given the designations BH-4, BH-5, and BH-6. A bullet fragment (item #761) was recovered from the hole designated BH-4 (corresponded to BH-1 in LMC-4). Another bullet fragment (item #762) was recovered from the hole designated BH-5 (corresponded to BH-3 in LMC-4). The bullet fragment forming BH-6 was actually recovered from the north wall, adjoining LMC-3.

The north wall of the office also contained three apparent bullet holes designated BH-1, BH-2, and BH-3. There were no bullet fragments located in these holes.

Type of Report Crime Scene	Agent Barie W. Goetz	Date 10/03/99	File Number P99-0453 D99-1333	Page 15
-------------------------------	-------------------------	------------------	-------------------------------------	------------

LMC-5 was the northernmost office in the northwest library hallway. LMC-5 had one window on the west wall and one on the north wall. A small wooden table, black metal audio-visual cart, and chair were located against the south wall of the office. A green metal audio-visual cart was against the east wall directly south of the entrance.

There were seven apparent bullet holes in the south wall of LMC-5. The holes were labeled BH-6 (corresponded to BH-1 in LMC-4), BH-7, BH-8 (corresponded to BH-3 in LMC-4), BH-9 (corresponded to BH-2 in LMC-4), and BH-10. BH-7 contained the copper jacketing associated with lead fragment item #761. BH-10 contained two copper jackets (one associated with item #762) and one lead bullet fragment (item #767). There were also numerous secondary missile impact sites in the area of BH-10 consistent with small glass fragments projected towards the wall, with the bullet fragments, from the north window.

The window on the north wall had five bullet holes through it (three through the glass, two through the frame). No bullet fragments were located in these five holes. The holes were labeled BH-1 (corresponded to item #764), BH-2 (corresponded to BH-6 and BH-7), BH-3 (corresponded to BH-10), BH-4 (corresponded to BH-8 and BH-10), and BH-5 (corresponded to BH-9). It was determined through glass fracture analysis that the sequence for the bullet holes in the north window glass of LMC-5 was as follows:

1. BH-2
2. BH-3
3. BH-4

The following chart explains bullet hole correspondence for LMC-5 through LMC-3 going from north-to-south:

Ext.	LMC-5 North	LMC-5 South	LMC-4 North	LMC-4 South	LMC-3 North
BH-1	BH-1	ON FLOOR (#764)			
BH-2	BH-2	BH-6/BH-7	BH-1	BH-4	IN WALL (#761)
BH-3	BH-3	BH-10			
BH-4	BH-4	BH-8/BH-10	BH-3	BH-5	IN WALL (#762)
BH-5	BH-5	BH-9	BH-2	BH-6	IN WALL (#763)

Type of Report Crime Scene	Agent Barie W. Goetz	Date 10/03/99	File Number P99-0453 D99-1333	Page 16
-------------------------------	-------------------------	------------------	-------------------------------------	------------

The five bullet holes in the north window and frame of LMC-5 were also documented from the exterior north library wall. In addition, two bullet impact sites were located in the north wall between the north window of LMC-5 and the emergency exit door at the north end of the library hallway.

There were several bullet impact sites in the hallway at the northwest corner of the library. All of the bullet trajectories were traveling south. A wooden twenty-drawer map storage cabinet, located against the east hallway wall, had three bullet impact holes on the north side of the cabinet. Two of the bullets (BH-1 and BH-3) were recovered inside the cabinet. One bullet (item #757) was embedded in the wood of the south edge of drawer #10 from the top and was facing south. One bullet (item #755) traveled through the map cabinet (BH-2 to BH-4), exited the map cabinet then entered the rear of the television cabinet to the south of the map cabinet. Upon making contact with the front frame of the television on the west side, the bullet made a dramatic turn to the east and exited between the plastic face and glass screen of the television set. The bullet then traveled east and struck the east wall. The bullet was recovered from the floor beneath the television cart. Wallboard material was observed on the nose of the bullet at the time of collection.

At the south end of the hallway, on the east wall separating the hallway from the conference room, there were several bullet impact sites. One bullet impacted the upper northern frame of a chair (CH1) along the east wall. The bullet impact (designated impact #1) sent smaller pieces of metal across the wall and through a picture frame on the east wall at the south end. A second bullet impact (designated impact #2) struck the wallboard to the south of CH1 and impacted below the computer table. Team Two recovered that bullet. The third bullet impact (designated impact #3) struck the wood corner molding at the south end of the east wall. The projectile then traveled south and hit a Macintosh computer monitor on the computer table. All three impact sites were tested with sodium rhodizinate with positive results for lead. A fourth projectile also passed through the lower back (south) partition under the computer table and was designated projectile hole #1A by Team Two. A minimum of 15 projectiles was determined to have been fired from

Type of Report Crime Scene	Agent Barie W. Goetz	Date 10/03/99	File Number P99-0453 D99-1333	Page 17
-------------------------------	-------------------------	------------------	-------------------------------------	------------

the north end of the library, down through the northwest hallway and offices towards the south.

The conference room was located on the southeast end of the hallway and directly west of the library magazine storage room. The conference room consisted of a large wood top conference table, surrounded by six padded chairs, in the center of the room. A small table was to the west of the entrance along the north wall of the conference room. A large paper writing pad on an easel was located in the southeast corner of the room. There was a bullet hole in the north wall of the conference room on the west edge of the doorframe. The trajectory of the bullet was traveling south into the conference room. As the bullet passed through the wall it fragmented. Several copper and lead fragments were found on the floor, tabletop, chairs (Chairs "A" and "D") and the south wall. A bullet hole was located in the floor molding of the south wall. The largest of the lead fragments (item #752) was located in the south wall under the easel. An apparent bullet wipe was found on the conference room floor in the southeast quadrant of the room. The wipe was in line with the bullet hole impact area on the floor molding. The area tested positive for lead with sodium rhodizinate.

The magazine storage room was located directly east of the library conference room. Entry into the room could be gained by either the conference room or the staff service area. The room was comprised of two rows of magazine stacks as well as shelving on the south and west walls. No evidence was located in this room. Both doors were open and unlocked upon arrival.

The staff service area was located at the northern end of the main library. The area was comprised of a large wood countertop work area. There were two computer terminals centered in the service counter, which faced south. Inspection of the area revealed that an under-the-counter telephone (presumably for staff use) was off the hook with the receiver on the floor behind the counter. One of the blue cushioned bar stool style chairs from the computer terminal area had apparent bullet hole damage to it. The chair was found on top of the counter to the east of the easternmost computer terminal. The computer monitor was off center of the CPU to the west and had scuffs on the front of it indicating that the chair had been thrown onto the counter striking the computer

Type of Report Crime Scene	Agent Barie W. Goetz	Date 10/03/99	File Number P99-0453 D99-1333	Page 18
-------------------------------	-------------------------	------------------	-------------------------------------	------------

monitor.

A small rectangular wooden printer stand cabinet was located at the northwest end of the staff service counter. The cabinet was open to the east and 100 sheet packs of white (8 1/2"x11") printer paper were stored under the counter on the staff (east) side. A computer printer (HP Laser Jet 5si/mx) was essentially centered on top of the cabinet. There were at least 14 shotgun pellet impact sites on the wood frame of the cabinet, some caused by ricocheted pellets. At least three pellets also struck the east side of the upper northwest paper bundle (item #735). No on-site examination or extraction of pellets was performed. One pellet (item #699) was recovered from the lower paper tray of the HP printer east side. Five other pellet impact sites were located on the west side wall of the westernmost staff seating area (access panel location) directly south of the printer cabinet. Additional items of evidence were recovered from the floor and countertop areas of the staff service section (see evidence report).

Type of Report Crime Scene	Agent Barie W. Goetz	Date 10/03/99	File Number P99-0453 D99-1333	Page 19
-------------------------------	-------------------------	------------------	-------------------------------------	------------

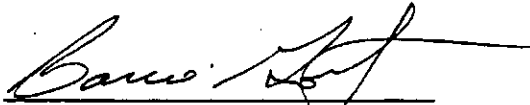

Barie W. Goetz
Lead Agent
CBI Pueblo
(Reporting)



Ted Ritter
Agent
CBI Denver
(Reporting)

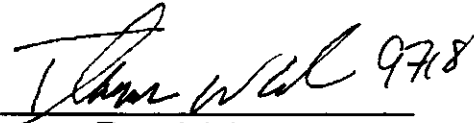

Tom Adair
Senior Laboratory Technician
Arapahoe County Sheriff's Office
(Reporting)

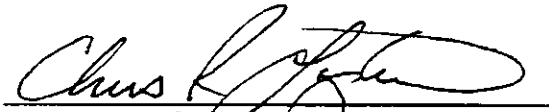

Chris Loptien
Forensic Chemist/Criminalist
Jefferson County Sheriff's Office
(Reporting)



Donald Sollars
Agent
CBI Denver
(Reporting)

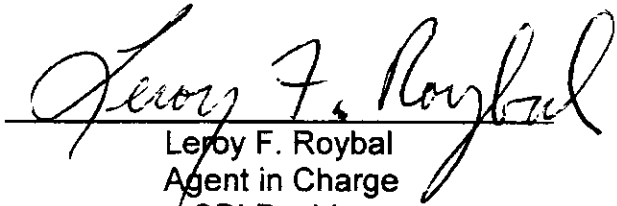

Leroy F. Roybal
Agent in Charge
CBI Pueblo
(Reviewing)

Type of Report Crime Scene	Agent Barie W. Goetz	Date 10/03/99	File Number P99-0453 D99-1333	Page 20
-------------------------------	-------------------------	------------------	-------------------------------------	------------

Photolog

Team #One

Roll WT-1

- 1 No photo
- 2 Card
- 3 Entrance to library
- 4 Entrance to library
- 5 Entrance to library behind service counter

- 6 Entrance to library security bars
- 7 Entrance to video room
- 8 Library security bars
- 9 Glass case at entrance to library
- 10 Sitting chairs at entrance to library

- 11 Section 1, eastside of library
- 12 Section 1, eastside of library
- 13 Overall Body #1
- 14 Overall Body #1
- 15 Overall Body #1

- 16 Overall Body #1
- 17 Overall Body #1
- 18 Glass case at entrance to library
- 19 Section 1, eastside of library
- 20 Section 1, eastside of library

- 21 Section 1, east side of library
- 22 Overall Body #2
- 23 Overall Body #2
- 24 Overall Body #2
- 25 Overall Body #2

- 26 Overall Body #2
- 27 Overall Body #3
- 28 Overall Body #3
- 29 Overall Body #3
- 30 Overall Body #3

Type of Report Crime Scene	Agent Barie W. Goetz	Date 10/03/99	File Number P99-0453 D99-1333	Page 21
-------------------------------	-------------------------	------------------	-------------------------------------	------------

Roll WT-1 continued

31	Overall Body #3
32	Overall Section 1
33	Overall Section 1
34	Overall Body #3 and Section 1
35	Overall Section 1
36	Overall Section 1
37	Overall between rows 2 and 3

Roll WT-2

1	Overall between rows 2 and 3
2	Card
3	Overall between rows 2 and 3
4	Overall between rows 3 and 4
5	Overall between rows 3 and 4
6	Overall of section 2
7	Overall of section 2
8	Overall of section 2
9	Overall of section 2
10	Overall of section 2
11	Overall of Body #4
12	Overall of Body #4
13	Overall of Body #4
14	Overall of Body #5
15	Overall of Body #5
16	Overall of Body #5
17	Overall of Body #5
18	Overall of section 2
19	Overall of section 2
20	Overall of section 2
21	Overall of front service counter
22	Overall of front service counter
23	Overall of front security bars
24	North end of rows 3 and 4
25	Overall between rows 5 and 6

Type of Report Crime Scene	Agent Barie W. Goetz	Date 10/03/99	File Number P99-0453 D99-1333	Page 22
-------------------------------	-------------------------	------------------	-------------------------------------	------------

Roll WT-2 continued

26	Overall between rows 5 and 6
27	Overall of section 3
28	Overall of section 3
29	Overall of section 3
30	Overall of Body #10
31	Overall of Body #10
32	Overall of Body #10
33	Overall of black trench coat in section 3
34	Overall of section 3
35	Overall of section 3
36	Overall of section 3
37	Overall of section 3

Roll WT-3

1	Card
2	Overall of Bodies #6 and #7
3	Overall of Bodies #6 and #7
4	Overall of Bodies #6 and #7
5	Overall of Bodies #6 and #7
6	Overall of Body #8
7	Overall of Body #8
8	Overall of Body #9
9	Overall of Body #9
10	Overall of Body #9
11	Overall of Body #9
12	Overall of Bodies #11 and #12
13	Overall of Bodies #11 and #12

Roll WT-4

1	Card
2	Overall of Bodies #11 and #12
3	Overall of Bodies #11 and #12
4	Midrange of Body #11
5	Midrange of Body #12

Type of Report Crime Scene	Agent Barie W. Goetz	Date 10/03/99	File Number P99-0453 D99-1333	Page 23
-------------------------------	-------------------------	------------------	-------------------------------------	------------

Roll WT-4 continued

- 6 Midrange of Body #11
- 7 Overall of section 3
- 8 Overall of section 3
- 9 Overall of section 3
- 10 Overall of storage room entrance with Body #13

- 11 Overall of Body #13
- 12 Overall of Body #13
- 13 Overall of Body #13
- 14 Overall of Body #13
- 15 Overall of Body #13

- 16 Body #1 with placard
- 17 Body #2 with placard
- 18 Body #3 with placard
- 19 Body #4 with placard
- 20 Body #5 with placard

- 21 Body #6 with placard
- 22 Body #7 with placard
- 23 Body #8 with placard
- 24 Body #9 with placard
- 25 Body #10 with placard

- 26 Body #11 with placard
- 27 Body #12 with placard
- 28 Body #13 with placard

Roll #1

- 1 Card
- 2 Library entrance
- 3 Entryway
- 4 Overall East section
- 5 Overall East section

- 6 Overall Reference desk
- 7 Entryway looking out
- 8 Section 1
- 9 Section 1
- 10 Section 1, South

Type of Report Crime Scene	Agent Barie W. Goetz	Date 10/03/99	File Number P99-0453 D99-1333	Page 24
-------------------------------	-------------------------	------------------	-------------------------------------	------------

Roll #1 continued

- 11 Bodies #1 and #2, overall - South
- 12 Bodies #1 and #2, overall - South
- 13 Bodies #1 and #2, overall
- 14 Section 1 - South
- 15 Body #3 - East

- 16 Body #3 - Northeast
- 17 Section 1 - North
- 18 Body #3 - North
- 19 Section 2 - South
- 20 Section 2 - South

- 21 Section 2 - South, with Body #5
- 22 Aisle way - South, between Rows 3 and 4
- 23 Aisle way - South, between Rows 3 and 4
- 24 Body #5 - North
- 25 Body #4 - West

- 26 Section 2 - North, with Body #4
- 27 Section 2 - North
- 28 Aisle way - South, between Rows 2 and 3
- 29 Aisle way - South, between Rows 2 and 3
- 30 No photo

- 31 **#600, 601** midrange
- 32 **#601** close-up
- 33 **#600** close-up
- 34 **#602, 603, 604, 605** midrange
- 35 **#602** close-up

Roll #2

- 1 Card
- 2 **#603** close-up
- 3 **#604** close-up
- 4 **#605** close-up
- 5 **#629** midrange, also 600 and 601 midrange

- 6 **#629** close-up
- 7 **#606** close-up
- 8 **#607** close-up
- 9 **#608** close-up
- 10 **#609** close-up

Type of Report Crime Scene	Agent Barie W. Goetz	Date 10/03/99	File Number P99-0453 D99-1333	Page 25
-------------------------------	-------------------------	------------------	-------------------------------------	------------

Roll #2 continued

11	#610, 611 close-up
12	#609, 611, 613, 614, 615 midrange
13	#612 midrange
14	#612 close-up
15	#613, 614 close-up
16	#615 close-up
17	#616, 617, 618, 619, 621 midrange
18	#616, 618 close-up
19	#619, 620 close-up
20	#617, 619, 620, 621 midrange
21	None
22	#621 close-up
23	#622, 623, 631 midrange
24	#631 close-up
25	#622 close-up
26	#623 close-up
27	#624 midrange
28	#624 close-up
29	#632 midrange
30	#632 close-up
31	#625 midrange
32	#625 close-up
33	#627, 628, 633 midrange
34	#633 close-up
35	#627 close-up

Roll #3

1	Card
2	None
3	#628 close-up
4	#634, 635 midrange
5	#634 close-up
6	#635 close-up
7	#636, 637 midrange
8	#636 close-up
9	#637 close-up

Type of Report Crime Scene	Agent Barie W. Goetz	Date 10/03/99	File Number P99-0453 D99-1333	Page 26
-------------------------------	-------------------------	------------------	-------------------------------------	------------

Roll #3 continued

10	Table 2
11	Table 2
12	Table 2 papers
13	Table 2 papers
14	Table 2 papers
15	Body #1
16	Body #1, back of Body with scale
17	Body #1, back of Body with scale
18	Body #1, bullet holes inside table end
19	Body #1, bullet holes inside table end
20	Body #1
21	Body #1
22	Body #1, feet of Body
23	Body #2
24	Body #2
25	Body #2
26	Body #2 upper
27	Body #2, midrange, back wound
28	Body #2 back wound
29	Body #2 back wound with scale
30	#636, 637, 638, 639, 640 midrange
31	#636 close-up
32	#637 close-up
33	#638 close-up
34	#639 close-up
35	#640 close-up

Roll #4

1	Card
2	Body #1, left buttocks, rip in jeans
3	Body #1, body removed by coroner, midrange
4	Body #1, body removed by coroner, midrange
5	Body #1, body removed by coroner, midrange
6	Body #1, body removed by coroner, midrange
7	Body #1, body removed by coroner, midrange

Type of Report Crime Scene	Agent Barie W. Goetz	Date 10/03/99	File Number P99-0453 D99-1333	Page 27
-------------------------------	-------------------------	------------------	-------------------------------------	------------

Roll #4 continued

8	Body #1, body removed by coroner, midrange
9	Body #2, body removed by coroner, midrange
10	Body #2, body removed by coroner, midrange
11	Body #2, #643 midrange
12	#643 close-up
13	Body #2, body removed by coroner, midrange
14	Body #2, body removed by coroner, midrange
15	Body #2, body removed by coroner, midrange
16	#641 midrange
17	#641 close-up
18	#642 midrange
19	#642 close-up
20	#644 midrange
21	#644 close-up
22	#639, 645 midrange
23	#645 close-up
24	Table 1
25	Table 3
26	Table 3
27	Table 4
28	Table 4 paper
29	Table 5
30	None (Table 5, no flash)
31	None (Table 5, no flash)
32	Table 5
33	None (Table 6, no flash)
34	Table 6
35	Table 6

Roll #5

1	None (No flash)
2	Card
3	Table 7
4	Table 8
5	Table 8

Type of Report Crime Scene	Agent Barie W. Goetz	Date 10/03/99	File Number P99-0453 D99-1333	Page 28
-------------------------------	-------------------------	------------------	-------------------------------------	------------

Roll #5 continued

6	Table 9
7	Table 10
8	Table 11
9	Table 11
10	Table 12
11	None (Table 13 no flash)
12	Table 13
13	Table 14
14	Chair, pack – south wall, section 2
15	#663, 664, 665 midrange
16	#663 close-up
17	None (#664 close-up, no flash)
18	#664 close-up
19	#665 close-up
20	#662, 661 midrange
21	#661 close-up
22	#662 close-up
23	#660 midrange
24	#660 close-up
25	#653-656 midrange
26	#653 close-up
27	#654 close-up
28	#655 close-up
29	#656 close-up
30	Body #3
31	Body #3
32	Body #3
33	#646, 647, 648, 649, 650, 666 midrange
34	#657 midrange
35	#659 midrange

Roll #6

1	None (No flash)
2	Card
3	#646, 666, 668, 669, 647, 648, 649, 650 midrange
4	#651, 652, midrange

Type of Report Crime Scene	Agent Barie W. Goetz	Date 10/03/99	File Number P99-0453 D99-1333	Page 29
-------------------------------	-------------------------	------------------	-------------------------------------	------------

Roll #6 continued

5	#651 close-up
6	#652 close-up
7	#668 close-up
8	#666 close-up
9	None
10	#646 close-up
11	#648 close-up
12	#649 close-up
13	#647 close-up
14	#650 close-up
15	#657 close-up
16	#669 close-up
17	#667 midrange
18	#667 close-up
19	#659 close-up
20	#658 midrange
21	#658 close-up
22	#670 midrange
23	#670 close-up

Roll #7

1	Card
2	Body #3, body removed by coroner, midrange
3	Body #3, body removed by coroner, midrange
4	Body #3, body removed by coroner, midrange
5	#677, 678 midrange
6	#677 close-up
7	#678 close-up
8	Body #5, midrange
9	Body #5, midrange
10	Body #5, midrange
11	Body #5, midrange
12	#671, 672, 673 midrange
13	#673 close-up
14	#672 close-up

Type of Report Crime Scene	Agent Barie W. Goetz	Date 10/03/99	File Number P99-0453 D99-1333	Page 30
-------------------------------	-------------------------	------------------	-------------------------------------	------------

Roll #7 continued

- 15 **#671** close-up
- 16 **#679** midrange
- 17 **#679** close-up
- 18 Body #5, right hand
- 19 Body #5, pants legs
- 20 Chairs 10, 11, Body #5
- 21 Chairs 10, 11, Body #5
- 22 Chair 10 front, underside
- 23 Chair 10 front, underside

Roll #8

- 1 Card
- 2 **#674, 675, 680** midrange
- 3 **#674** close-up
- 4 **#675** close-up
- 5 **#680** close-up
- 6 Body #5, right arm
- 7 Body #5, body removed by coroner
- 8 Body #5, body removed by coroner
- 9 Body #5, body removed by coroner
- 10 Body #5, body removed by coroner
- 11 Body #4
- 12 Body #4
- 13 Body #4
- 14 Body #4
- 15 Body #4
- 16 Body #4
- 17 Body #4
- 18 Body #4
- 19 Body #4, pack and cut strap
- 20 **#681** midrange
- 21 **#681** close-up
- 22 **#682** midrange
- 23 **#682** close-up

Type of Report Crime Scene	Agent Barie W. Goetz	Date 10/03/99	File Number P99-0453 D99-1333	Page 31
-------------------------------	-------------------------	------------------	-------------------------------------	------------

Roll #9

- 1 Card
- 2 Body #4, left arm
- 3 #682, Body #4, hole in carpet, left arm
- 4 Body #4, body removed by coroner
- 5 Body #4, body removed by coroner

- 6 Body #4, back, shirt up
- 7 Body #4 front, body removed by coroner
- 8 Body #4 front, body removed by coroner
- 9 Body #4 front, body removed by coroner
- 10 Body #4 chest, body removed by coroner

- 11 #683 midrange
- 12 #683 close-up
- 13 #684 midrange
- 14 #684 close-up
- 15 #685 midrange

- 16 #686 close-up
- 17 #686 midrange
- 18 #686 close-up
- 19 #687 midrange
- 20 #687 close-up

- 21 #688 midrange
- 22 #688 close-up

Roll #10

- 1 Card
- 2 Center Island, 1, 2
- 3 Center Island, 1, 2
- 4 Center Island, 1
- 5 Center Island, 1, 2

- 6 Center Island, 1, 2
- 7 Staff service area
- 8 Staff service area
- 9 Staff service area
- 10 Staff service area, damaged chair on counter

Type of Report Crime Scene	Agent Barie W. Goetz	Date 10/03/99	File Number P99-0453 D99-1333	Page 32
-------------------------------	-------------------------	------------------	-------------------------------------	------------

Roll #10 continued

- 11 Staff service area, damaged chair on counter
- 12 Staff service area, damaged chair on counter
- 13 Staff service area, damaged chair on counter
- 14 Staff service area
- 15 Staff service area, damaged chair behind counter

- 16 Staff service area
- 17 Staff service area
- 18 Staff service area
- 19 Center support and Table 1 showing objects, midrange
- 20 Center support and Table 1, close-up

- 21 Center support and Table 1, close-up
- 22 Chair 1A, back
- 23 Chair 1A, back
- 24 Chair 1A, front
- 25 Chair 1A, front

- 26 Chair 1A, seat
- 27 Chair 1A, seat
- 28 Chair 1A, trajectory rod
- 29 Chair 1A, trajectory rod
- 30 Chair 1A, trajectory rod

- 31 #690 midrange
- 32 #690 close-up

Roll #11

- 1 Card
- 2 None
- 3 A. Thomas, backpack
- 4 #691 midrange
- 5 #691 close-up

- 6 B. Anderson, backpack
- 7 #692, 695, 696, 697 midrange
- 8 #692 close-up
- 9 #695 close-up
- 10 #696 close-up

- 11 #697 close-up

Type of Report Crime Scene	Agent Barie W. Goetz	Date 10/03/99	File Number P99-0453 D99-1333	Page 33
-------------------------------	-------------------------	------------------	-------------------------------------	------------

Roll #11 continued

- 12 #693, 694 midrange
- 13 #693 close-up
- 14 #694 close-up
- 15 #698, 699, 700 midrange

- 16 #698 close-up
- 17 #700 close-up
- 18 #699 close-up
- 19 #701 midrange
- 20 #701 close-up

- 21 #703 midrange
- 22 #703 close-up
- 23 Medium range, #699 showing metallic fragment in bottom tray of copier
- 24 Close-up, #699 showing metallic fragment in bottom tray of copier
- 25 Midrange #704, Table 6

- 26 #704 Table 6, top
- 27 #704 Table 6, top
- 28 #704 Table 6, North end
- 29 #705 Table 5, top – blood on floor
- 30 #706 blood on carpet behind Chair 2A

- 31 #707 Northeast corner, Table 2, blood on floor
- 32 #717 Eastside, Table 2, blood on floor
- 33 #712 Body #2, blood on floor
- 34 #708 Southwest corner, Table 2, blood on floor
- 35 #716 under Table 2, blood on floor

- 36 #713 Body #1, Northwest corner, Table 2, blood on floor

Roll #12

- 1 Card
- 2 #709 blood on carpet between Rows 2 and 3
- 3 #710 side end, Row 4, Southeast corner, Table 9
- 4 #711 Body #3, blood on carpet, South side, Table 6
- 5 #714 Body #5, blood on carpet

Type of Report Crime Scene	Agent Barie W. Goetz	Date 10/03/99	File Number P99-0453 D99-1333	Page 34
-------------------------------	-------------------------	------------------	-------------------------------------	------------

Roll #12 continued

- 6 **#715** Body #4, Southwest side, under Table 14, blood on carpet
- 7 **#718** blood on East end, Table 1
- 8 **#719** bottom, Row 1
- 9 **#720** trash can entry corner
- 10 **#720** close-up

- 11 **#721** Body #1, backpack
- 12 **#722** Table 2
- 13 **#723, 724, 725**, Table 4
- 14 **#726, 727, 728**, Table 6
- 15 **#729** beside Table 14

- 16 **#730** beside Table 9
- 17 **#731** Table 9
- 18 **#738**, #1 stool, front, staff service area
- 19 **#738**, #1 stool, back
- 20 **#738**, #1 stool, front/scale

- 21 **#738**, #1 stool, back/scale
- 22 Inside staff service area counter, West end
- 23 Inside staff service area counter, West end
- 24 **#732-735, 739, 740** midrange
- 25 **#732-735, 739, 740** midrange

- 26 **#732, 733**
- 27 **#735**
- 28 **#734**
- 29 **#739, 740**

Roll #13

- 1 Card
- 2 **#741** midrange, bullet under carpet in thick stain
- 3 **#741** Midrange, bullet under carpet in thick stain (Body #3)
- 4 **#741** carpet under Body #3
- 5 **#741** close-up of bullet core beside copper jacket under carpet

- 6 **#742** overall, underchair
- 7 **#742** midrange
- 8 **#742** close-up

Type of Report Crime Scene	Agent Barie W. Goetz	Date 10/03/99	File Number P99-0453 D99-1333	Page 35
-------------------------------	-------------------------	------------------	-------------------------------------	------------

Roll #13 continued

- 9 **#743** midrange
- 10 **#743** close-up

- 11 **#744** midrange
- 12 **#744** close-up
- 13 Overall photo of trajectory rods in place, South of Table 6
and Chair 6D
- 14 Overall photo of trajectory rods in place, South of Table 6
and Chair 6D, No flash
- 15 Photo of Chair 6D with trajectory rod showing approximately
15° downward, repositioned

- 16 Overhead shot, Table 6, showing Chair 5G
- 17 Chair 5G at Table 6
- 18 Chair 5G with trajectory rod, repositioned
- 19 Chair 5G with trajectory rod, repositioned
- 20 Overall mirror, South wall with trajectory rod

- 21 Midrange mirror, trajectory rod through mirror, into wall
- 22 Close-up, trajectory rod through mirror into wall
- 23 Overall, possible shooter position – mirror/Body #3
(possible problems with camera – rewind on)
- 24 Overall, possible shooter position – mirror/Body #3
(possible problems with camera – rewind on)
- 25 Overall, possible shooter position – mirror/Body #3
No flash

- 26 Overall, possible shooter position – mirror/Body #3
No flash
- 27 Overall, convergence/mirror
- 28 Overall, convergence/mirror
- 29 Overall, convergence/mirror
- 30 Overall, convergence/mirror

- 31 Convergence aspirated/expirated blood, Table 6
- 32 Close-up, convergence aspirated/expirated blood, Table 6
- 33 North end, Table 6
- 34 North end, Table 6
- 35 North end, Table 6

Type of Report Crime Scene	Agent Barie W. Goetz	Date 10/03/99	File Number P99-0453 D99-1333	Page 36
-------------------------------	-------------------------	------------------	-------------------------------------	------------

Roll #14

- 1 Card
- 2 #744 trajectory rod
- 3 Overall trajectory rod, #744, tables 3 and 4, South, downward 10°
- 4 #745 mirror with copper jacket
- 5 #746 bullet from wall above window, 3rd from East

- 6 #768, copper jacket, 3S, 25E ceiling panel
- 7 #768, copper jacket, 3S, 25E ceiling panel
- 8 Entrance from hall/ceiling #768
- 9 Entrance from hall/ceiling #768
- 10 Exterior hall, #768/1281

- 11 Landing steps to #768/1281 long range
- 12 Landing steps to #768/1281 midrange
- 13 Bullet path 9E-1
- 14 Bullet path 9E-1 close-up
- 15 Reposition #1 9E-10D

- 16 Extreme angle 9E-10D
- 17 Opposite extreme angle 9E-2-10D
- 18 Opposite extreme angle 9E-2-10D
- 19 Opposite extreme angle 9E-2-10D
- 20 Body #5, carpet defect – possible direction of travel

- 21 Body #5, carpet defect – possible direction of travel
- 22 Body #5, carpet defect – possible direction of travel, mid-range
- 23 Body position #4, long range, Table 14 East-to-West
- 24 Close-up Body #4, possible path
- 25 180° of #24 West-to-East

- 26 180° of #24 West-to-East – close-up
- 27 Body #4, projectile paths - close-up
- 28 Body #4, projectile paths - close-up
- 29 Bullet hole, East wall/Table 2, #773
- 30 Bullet hole, East wall/Table 2, #773

- 31 #773 midrange
- 32 #773, out of focus
- 33 #773 recovery, close-up
- 34 #774, Table 2, leg, recovery

Type of Report Crime Scene	Agent Barie W. Goetz	Date 10/03/99	File Number P99-0453 D99-1333	Page 37
-------------------------------	-------------------------	------------------	-------------------------------------	------------

Roll #14 continued

35 None
36 #774, Table 2, leg, recovery, midrange

Roll #15

1 Card
2 #775 midrange
3 #775 close-up
4 #776 midrange
5 #776 close-up

6 #777 midrange
7 #777 close-up
8 #778 midrange
9 #778 close-up
10 #779 midrange

11 #779 close-up
12 Chair 1A, back
13 Chair 1A, back
14 Chair 1A, back
15 Chair 1A, front

16 Chair 1A, front
17 Chair 1A, front
18 Chair 1A, front
19 Chair 1A, front
20 #780 midrange

21 #780 midrange
22 Chair 1A front seat edge
23 Chair 1A seat with arrows
24 #780 Chair 1A with trajectory rods
25 #780 Chair 1A with trajectory rods

26 #780 Chair 1A with trajectory rods
27 #780 Chair 1A with trajectory rods
28 #780 Chair 1A with trajectory rods
29 #780 Chair 1A with trajectory rods
30 #780 bottom, Chair 1A with trajectory rods

31 #780 bottom, Chair 1A with trajectory rods

Type of Report Crime Scene	Agent Barie W. Goetz	Date 10/03/99	File Number P99-0453 D99-1333	Page 38
-------------------------------	-------------------------	------------------	-------------------------------------	------------

Roll #15 continued

32 Chair 1A, back entry, foam with scale
33 Chair 1A wood with scale, back entry
34 Chair 1A wood with scale, front exit
35 #781 under Table 1

36 #781 under Table 1
37 #781 pellet

Roll #16

1 Card
2 Chair 5G, back entry
3 Chair 5G, back entry
4 Chair 5G, front exit
5 Chair 5G, front exit

6 Chair 5G, front exit
7 Chair 5G, trajectory rod
8 #785 midrange
9 #785 close-up
10 #786 midrange, blood spot

11 #786 close-up
12 #784 chair, Table 9
13 #784 midrange, fragment
14 #784 close-up
15 #782, 783 midrange

16 #783 close-up, blood
17 #783 with scale
18 #782 midrange, blood
19 #782 with scale

Roll #17

1 Card
2 #732, 733, 734, 735, 739, 740, 699, 700, West end inside counter, staff service area, no flash, 698 with trajectory rod
3 #732, 733, 734, 735, 739, 740, 699, 700, West end inside counter, staff service area, 698 with trajectory rod
4 #732, 733, 734, 735, 739, 740, 699, 700, 698 with trajectory rod

Type of Report Crime Scene	Agent Barie W. Goetz	Date 10/03/99	File Number P99-0453 D99-1333	Page 39
-------------------------------	-------------------------	------------------	-------------------------------------	------------

Roll #17 continued

- 5 #732, 733, 734, 735, 739, 740, 699, 700, 698 with trajectory rod
- 6 #732, 733, 734, 735, 739, 740, 699, 700, 698 with trajectory rod
- 7 #796 panel West end, staff service area
- 8 Inside panel area
- 9 #797 inside panel area, midrange
- 10 #797 close-up
- 11 Inside panel area
- 12 Inside panel area, #798
- 13 #798 close-up (removed)
- 14 #799 inside panel area stuck in column
- 15 #800 copper coated pellet, close-up, no flash/focus
- 16 #800 copper coated pellet, close-up
- 17 #801 midrange
- 18 #801 close-up
- 19 #787, 788, 789 midrange
- 20 #788 close-up
- 21 #789 close-up
- 22 #790, 791, 792 midrange
- 23 #790 close-up
- 24 #792 close-up
- 25 #791 close-up

Roll #18

- 1 Card
- 2 #793 midrange
- 3 #793 close-up
- 4 #794 midrange
- 5 #794 close-up
- 6 #795 midrange
- 7 #795 close-up
- 8 #802 midrange
- 9 #802 close-up

Type of Report Crime Scene	Agent Barie W. Goetz	Date 10/03/99	File Number P99-0453 D99-1333	Page 40
-------------------------------	-------------------------	------------------	-------------------------------------	------------

Roll #19

- 1 Card
- 2 #803 midrange of videotape
- 3 #803 midrange, turned over showing defect
- 4 #803 close-up showing copper coated pellet in video cassette
- 5 #804 close-up of copper bullet jacket in Office 2, no flash
- 6 #804 close-up of copper bullet jacket in Office 2
- 7 Overall of impact #1, Office 2 with Sodium Rhodizinate test
- 8 Close-up - overall of impact #1, Office 2 with Sodium Rhodizinate test
- 9 Overall of outside North wall with BH-1 through BH-7
- 10 Overall of outside North wall (North window)
- 11 Overall of outside North wall from side showing trajectory rods (North window)
- 12 Overall of window showing arrows – side lighting
- 13 Closer shot of window showing arrows – side lighting
- 14 Closer shot of window showing arrows – side lighting
- 15 Closer shot of window showing arrows – top lighting, flash
- 16 Closer shot of window showing arrows – from West side
- 17 Closer shot of window showing arrows – from West side
- 18 LMC-5 room, overall, showing trajectory rods in metal frame of window
- 19 Overall LMC-5 room showing three trajectory rods in South wall, LMC-5
- 20 Overall LMC-5 room showing three trajectory rods in South wall, LMC-5, no flash
- 21 Overall LMC-5 room showing three trajectory rods in South wall, LMC-5
- 22 Overall of window LMC-5
- 23 Overall of trajectory rods in South wall, LMC-5, no flash
- 24 Overall of trajectory rods in South wall, LMC-5, no flash
- 25 Overall of trajectory rods in South wall, LMC-5, no flash

Type of Report Crime Scene	Agent Barie W. Goetz	Date 10/03/99	File Number P99-0453 D99-1333	Page 41
-------------------------------	-------------------------	------------------	-------------------------------------	------------

Roll #20

- 1 Card
- 2 Three trajectory rods in North wall of LMC-4
- 3 Three trajectory rods in North wall of LMC-4
- 4 Overall of BH-7 hallway from outside
- 5 Overall of BH-7 hallway in Office 2

- 6 Impact #3 hallway – string to computer (pink line)
- 7 Impact #2 – (yellow line) – string wall to computer desk
- 8 Overall with holes in computer desk and rod and string
- 9 Computer table, no flash
- 10 Overall of hallway, with rod and strings

- 11 Overall with holes in computer desk with both trajectory rods and strings
- 12 Close-up view of holes in computer desk with both trajectory rods and strings
- 13 Midrange of string and trajectory rods
- 14 Overall of string and trajectory rods down hall wall from open door
- 15 Overall of string and trajectory rods down hall wall from open door

- 16 From LMC-4 hallway with string
- 17 Hallway TV, divot mark outside West face, close-up
- 18 Hallway TV, divot mark outside West face, close-up
- 19 Inside bullet wipe mark on front of TV frame, midrange
- 20 Close-up, bullet wipe mark on front of TV frame

- 21 Close-up, bullet wipe mark on front of TV frame, oblique flash from below
- 22 Close-up, bullet wipe mark on front of TV frame, diffused flash
- 23 Corrected placard for #763
- 24 Corrected placard for #761

Type of Report Crime Scene	Agent Barie W. Goetz	Date 10/03/99	File Number P99-0453 D99-1333	Page 42
-------------------------------	-------------------------	------------------	-------------------------------------	------------

Roll #1A

- 1 Card
- 2 BH-4 and BH-5, medium range
- 3 BH-7 hallway
- 4 BH-7 with scale
- 5 BH-8 hallway

- 6 BH-8 hallway
- 7 BH-8 hallway with scale
- 8 BH-9 in frame of picture
- 9 BH-9 mark in poster
- 10 BH-9 mark in poster with scale

- 11 Impact in South side of poster frame
- 12 Impact in South side of poster frame with scale
- 13 Impact in South side of poster frame with scale
- 14 Overall of markings on wall
- 15 Overall of markings on wall

- 16 Overall of markings on wall
- 17 Close-up of marking in wood trim
- 18 Medium shot of impact on wall behind chair
- 19 Medium shot of impact on wall behind chair with scale
- 20 Medium shot of impact behind chair

- 21 Medium shot of impact behind chair with scale
- 22 Medium shot of impact behind chair
- 23 Medium shot of impact behind chair with scale
- 24 Medium shot of impact on wood trim
- 25 Medium shot of impact on wood trim with scale

- 26 BH-1, Office 2
- 27 BH-1, Office 2 with scale
- 28 BH-2, Office 2
- 29 BH-2, Office 2 with scale
- 30 BH-3, Office 2

- 31 BH-3, Office 2 with scale
- 32 Impact #1, Office 2
- 33 Impact #1, Office 2 with scale
- 34 Overall, BH-2 and BH-3 and impact #1
- 35 Overall, BH-2 and BH-3 and impact #1

- 36 Overall, BH-1, Office 2

Type of Report Crime Scene	Agent Barie W. Goetz	Date 10/03/99	File Number P99-0453 D99-1333	Page 43
-------------------------------	-------------------------	------------------	-------------------------------------	------------

Roll #2A

- 1 Card
- 2 Overall video – 2 room (North)
- 3 Overall video – 2 room (Northeast)
- 4 Overall video – 2 room (hallway entrance)
- 5 Overall video – 2 room (South)

- 6 Overall video – 2 room (Southwest)
- 7 Overall video – 2 room (West)
- 8 Overall, video "set" (North)
- 9 Overall, video "set" (Northwest)
- 10 Overall, video "set" (West)

- 11 Overall, video "set" (South)
- 12 Overall, video "set" (East)
- 13 Overall, video "set" (North)
- 14 Video camera standing
- 15 Video camera on floor

- 16 Overall, video "set" (South)
- 17 Overall, video "set" (Southwest)
- 18 Overall, video "set" (West)
- 19 Video production room entrance, overall
- 20 Video production room entrance (West wall)

- 21 Video room, overall
- 22 Video room (North wall)
- 23 Video room (Northwest wall)
- 24 Video room (West wall)
- 25 Videos in box on floor

- 26 Videos on shelf in room
- 27 Two purses on floor
- 28 Video recorder with video inside
- 29 Batteries taped together
- 30 Video machine in room with refrigerator

- 31 #747 close-up
- 32 #747 with scale
- 33 #748
- 34 #748 with scale
- 35 #749
- 36 #749 with scale

Type of Report Crime Scene	Agent Barie W. Goetz	Date 10/03/99	File Number P99-0453 D99-1333	Page 44
-------------------------------	-------------------------	------------------	-------------------------------------	------------

Roll #3A

1	Card
2	#752
3	#752 with scale
4	#751, 753
5	#751 with scale
6	#753 with scale
7	#754 chair (2 holes)
8	#754 with scale
9	#754 with scale
10	#750
11	#750 with scale
12	#750 with scale
13	#755
14	#755 with scale
15	#757
16	#757 with scale
17	#758, 757 overall
18	#758 with scale
19	#759
20	#761
21	#762
22	#763
23	#761-763
24	#758
25	#762
26	#762 with scale
27	#761
28	#761 with scale
29	#761 overall
30	#763
31	#763 with scale
32	Overall #763 and #762
33	Overall #761, 762, 763
34	#753
35	#753 with scale
36	#751 with scale (no evidence)

Type of Report Crime Scene	Agent Barie W. Goetz	Date 10/03/99	File Number P99-0453 D99-1333	Page 45
-------------------------------	-------------------------	------------------	-------------------------------------	------------

Roll #4A

- 1 Card
- 2 #754 fragment lead
- 3 #754 with scale
- 4 #754 impact #2
- 5 #754 with scale

- 6 #752
- 7 #752 with scale
- 8 Penn State ball cap
- 9 #769 (bloodstain)
- 10 #769 with scale

- 11 #760 fragments
- 12 #760 with scale
- 13 Overall #769, hat, #1014
- 14 Overall room, Office 2
- 15 Overall room, Office 2

- 16 Outside BH in window and wall
- 17 Outside BH in window and wall
- 18 Outside BH in window and wall
- 19 Triple hole in window, overall
- 20 Single hole in window, overall

- 21 Single hole in window with scale
- 22 Cut hole in LMC-5, 3 fragments
- 23 Cut hole in LMC-5, 1 fragment BH-7
- 24 #766 section of drywall
- 25 Overall of windows

- 26 Overall of windows
- 27 #772
- 28 #772 with scale
- 29 #764
- 30 #764 with scale

- 31 #765
- 32 #765 with scale
- 33 Mark on wall by TV, overall
- 34 Mark on wall by TV, medium shot
- 35 Mark on wall by TV, close-up with scale
- 36 TV, mark in wall #755

Type of Report Crime Scene	Agent Barie W. Goetz	Date 10/03/99	File Number P99-0453 D99-1333	Page 46
-------------------------------	-------------------------	------------------	-------------------------------------	------------

Roll #5A

- 1 Card
- 2 Overall of #770 to North
- 3 Overall of #771 to North
- 4 Item #764 with placard
- 5 Overall of BH-6, BH-7 in LMC-5

- 6 Overall of BH-8, BH-9, BH-10 in LMC-5
- 7 Midrange of item #767
- 8 Midrange of item #767 with scale
- 9 Midrange of item #766
- 10 Midrange of item #766 with scale

- 11 Overall of BH-1 to Northwest
- 12 Overall of items #755 and TV cart
- 13 Overall of hallway wall East at South end near Chair H1 and BH-9
- 14 Overall of hallway wall East at South
- 15 Overall of hallway with "Impact" written

- 16 Impact #2 with scale
- 17 Impact #3 with scale
- 18 Impact #1 with scale
- 19 Overall of hallway with impact sites 1-3 and BH-9
- 20 Close-up of #759 with scale

Roll #1B

- 1 Card
- 2 Entrance to magazine archive room
- 3 Overall to Northwest in room
- 4 Overall to North of room
- 5 Entrance from conference room

- 6 Western aisle to South
- 7 Conference entrance to East
- 8 Western aisle to North
- 9 Center aisle to North
- 10 Eastern aisle to North

- 11 Western aisle to South
- 12 Center aisle to South
- 13 Eastern aisle to South

Type of Report Crime Scene	Agent Barie W. Goetz	Date 10/03/99	File Number P99-0453 D99-1333	Page 47
-------------------------------	-------------------------	------------------	-------------------------------------	------------

Roll #1C

- 1 Card
- 2 Overall back hallway
- 3 Overall back hallway
- 4 Overall back hallway
- 5 Overall back hallway, south view

- 6 Overall fire exit door
- 7 Entrance LMC-5
- 8 Entrance Office 2
- 9 Overall map case
- 10 Overall LMC-5

- 11 South wall LMC-5
- 12 Overall of window on north wall of LMC-5
- 13 East wall LMC-5
- 14 Entrance LMC-4
- 15 West wall LMC-4

- 16 South wall LMC-4
- 17 South wall LMC-4
- 18 East wall LMC-4
- 19 North wall LMC-4
- 20 North wall LMC-4

- 21 Entrance LMC-3
- 22 West wall LMC-3
- 23 South wall LMC-3
- 24 South wall LMC-3
- 25 East wall LMC-3

- 26 North wall LMC-3
- 27 North wall LMC-3
- 28 Entrance LMC-2
- 29 West wall LMC-2
- 30 South wall LMC-2

- 31 South wall LMC-2
- 32 East wall LMC-2
- 33 North wall LMC-2
- 34 North wall LMC-2
- 35 White Penn State hat on floor
- 36 Bullet marks on east wall in back hallway
- 37 Bullet marks on east wall in back hallway

Type of Report Crime Scene	Agent Barie W. Goetz	Date 10/03/99	File Number P99-0453 D99-1333	Page 48
-------------------------------	-------------------------	------------------	-------------------------------------	------------

ROLL #2C

- 1 Card
- 2 Entrance LMC Office
- 3 West wall LMC Office
- 4 South wall LMC Office
- 5 South wall LMC Office

- 6 East wall LMC Office
- 7 North wall LMC Office
- 8 North wall LMC Office
- 9 Entrance Office 2
- 10 South wall Office 2

- 11 West wall Office 2
- 12 West wall Office 2
- 13 North wall Office 2
- 14 East wall Office 2
- 15 East wall Office 2

- 16 Bullet hole on outside entrance to Office 2
- 17 Bullet hole on inside of entrance to Office 2
- 18 Overall of bullet inside map cabinet
- 19 Midrange of bullet inside nap cabinet
- 20 Bullet hole 1 in LMC-5

- 21 Bullet hole 1 in LMC-5 with scale
- 22 Bullet hole 2 in window of LMC-5
- 23 Bullet hole 2 in window of LMC-5 with scale
- 24 Bullet holes 3 and 4 in window of LMC-5
- 25 Bullet holes 3 and 4 in window of LMC-5 with scale

Roll #3C

- 1 Card
- 2 Bullet hole 5 in window frame of LMC-5
- 3 Bullet hole 5 in window frame of LMC-5 with scale
- 4 Overall of window in LMC-5 with bullet holes 1-5
- 5 Overall of window in LMC-5 with bullet holes 1-5

- 6 Bullet hole 6 in LMC-5
- 7 Bullet hole 6 in LMC-5 with scale
- 8 Bullet hole 7 in LMC-5
- 9 Bullet hole 7 in LMC-5 with scale
- 10 Bullet hole 8 in LMC-5

Type of Report Crime Scene	Agent Barie W. Goetz	Date 10/03/99	File Number P99-0453 D99-1333	Page 49
-------------------------------	-------------------------	------------------	-------------------------------------	------------

Roll #3C continued

- 11 Bullet hole 8 in LMC-5 with scale
- 12 Bullet hole 9 in LMC-5
- 13 Bullet hole 9 in LMC-5 with scale
- 14 Bullet hole 10 in LMC-5
- 15 Bullet hole 10 in LMC-5 with scale

- 16 Overall south wall of LMC-5 with bullet holes 6-10
- 17 Overall south wall of LMC-5 with bullet holes 6-10
- 18 Midrange of bullet holes 6 and 7 in LMC-5
- 19 Midrange of bullet holes 8, 9 and 10 in LMC-5
- 20 Bullet hole 1 in LMC-4

- 21 Bullet hole 1 in LMC-4 with scale
- 22 Bullet hole 2 in LMC-4
- 23 Bullet hole 2 in LMC-4 with scale
- 24 Bullet hole 3 in LMC-4
- 25 Bullet hole 3 in LMC-4 with scale

ROLL #4C

- 1 Card
- 2 Overall North wall of LMC-4 with bullet holes 1-3
- 3 Bullet hole 4 in LMC-4
- 4 Bullet hole 4 in LMC-4 with scale
- 5 Bullet hole 5 in LMC-4

- 6 Bullet hole 5 in LMC-4 with scale
- 7 Bullet hole 6 in LMC-4
- 8 Bullet hole 6 in LMC-4 with scale
- 9 Overall of bullet hole 5 and 6 on south wall LMC-4
- 10 Overall of bullet hole 4 on south wall LMC-4

- 11 Bullet hole 1 in hallway map cabinet
- 12 Bullet hole 1 in hallway map cabinet with scale
- 13 Bullet hole 2 in hallway map cabinet
- 14 Bullet hole 2 in hallway map cabinet with scale
- 15 Bullet hole 3 in hallway map cabinet

- 16 Bullet hole 3 in hallway map cabinet with scale
- 17 Bullet hole 4 in hallway map cabinet
- 18 Bullet hole 4 in hallway map cabinet with scale
- 19 Bullet hole 5 in TV in hallway

Type of Report Crime Scene	Agent Barie W. Goetz	Date 10/03/99	File Number P99-0453 D99-1333	Page 50
-------------------------------	-------------------------	------------------	-------------------------------------	------------

Roll #4C continued

- 20 Bullet hole 5 in TV in hallway with scale
- 21 Bullet hole 6 in hallway map cabinet
- 22 Bullet hole 6 in hallway map cabinet with scale
- 23 Bullet hole 7 in doorframe to Office 2
- 24 Bullet hole 7 in doorframe to Office 2 with scale
- 25 Overall of bullet holes 1, 2, 3 and 6 in map cabinet

TEAM 1: 600-~~601~~ 619 EVIDENCE RECOVERY LOG TEAM 1

LOCATION: LIBRARY S.E. SIDE
 DATE: 04/21/99
 CASE REPORT NUMBER: 99-1625
 EVIDENCE INVESTIGATOR: CHRIS LOPTIER, ANDRUE KASKOVS, PHOTO LOG

ASSIGNED PERSONNEL: SCRIBE - SHAVELY, R. TTEE, CAR PHOTO, SOLICITOR, CBI MII, GOERTZ, CBI, LAP

042199
 X-DIAGRAM ON BACK

ITEM #	DESCRIPTION	WHERE FOUND	RECOVERED BY	DATE/TIME RECOVERED	PHOTO	SUBLIST? Y/N	PACKAGING METHOD	MISC. COMMENTS
600	SHELL CASING RP 9mm LUGER	FRONT DOOR, FLOOR, N. SIDE	C. LOPTIER	1551	Y			PUBLIC FLAG #8
601	SILVER DUCT TAPE FRAG	" "	C. LOPTIER	1553	Y			
602	SHELL CASING LUGER RP 9mm	FRONT DISPLAY CASE, 1' NORTH	C. LOPTIER	1554	Y			
603	SHELL CASING " "	1' WEST OF MAGNETOMETER	C. LOPTIER	1555	Y			
604	COPPER FRAGS, AX	INSIDE DISPLAYCASE	C. LOPTIER	1556	Y			
605	LEAD FRAG X 2	" "	C. LOPTIER	1558	Y			
606	COPPER FRAG 12 GA FERRIS DOBBIN	4' SOUTH CASE BOOKBACK, END OF BOOK ROW 3	C. LOPTIER	1623	Y			
607	SHOTGUN SHELL (FRAG) 2 1/4" RP 9mm	TARGE #1	C. LOPTIER	1725	Y			
608	SHELL CASING RP 9mm LUGER	2 1/2 FEET NE OF BODY #1 FEET	C. LOPTIER	1724	Y			
609	LEAD FRAG	2 FEET N OF BODY #1 FEET	C. LOPTIER	1626	Y			
610	SHOTGUN WADDER	1 1/2 FEET N OF BODY #1 FEET	C. LOPTIER	1628	Y			
611	" "	FRONT, 16 INCH EAST WALL BOOKBACK	C. LOPTIER	1629	Y			
612	" "	MIDWAY DETAIL - BODY #1 & 2	C. LOPTIER	1630	Y			
613	COPPER FRAG X 2	IN	C. LOPTIER	1631	Y			
614	" "	HAIR OF BODY #2	C. LOPTIER	1632	Y			
615	SHOTGUN WADDER	1 FOOT WEST OF BODY #2	C. LOPTIER	1633	Y			
616	ROUND COPPER LEAD FRAG	FLOOR, S.W. CORNER TABLE #2	C. LOPTIER	1634	Y			
618	GRAN 4'S SHIRT, BLOODY	" "	C. LOPTIER	1635	Y			BLOODY
619	10 COPPER LEAD FRAG	" "	C. LOPTIER	1640	Y			

EVIDENCE RECOVERY LOG

620-639

ASSIGNED GOETZ

PERSONNEL RITGER

SOARES

LOCATION LIBRARY

DATE 04/21/99

CASE REPORT NUMBER 99-1625

EVIDENCE INVESTIGATOR LOPTEN

SWANEN

4-21-99

*DIAGRAM ON BACK

ITEM #	DESCRIPTION	WHERE FOUND	RECOVERED BY	DATE/TIME RECOVERED	PHOTO	SUBLIST? Y/N	PACKAGING METHOD	MISC. COMMENTS
620	ROUND COPPER LENS FRAG	FRONT SW CORNER TABLE 2	C. LOPTEN	1643	Y			
621	"	"	C. LOPTEN	1644	Y			
622	SHELL CASING LEVER	1' N OF TABLE 3	C. LOPTEN	1756	Y			
623	"	NEXT TO TABLE 5, NORTH SIDE UNDER TABLE #1	C. LOPTEN	1758	Y			
624	SHELL CASING	RP 9mm S.W. SIDE MIDDLEWAY + NEXT TO BOOK ROW #3	C. LOPTEN	1803	Y			
625	SHELL CASING	RP 9mm FLOOR END OF BOOK ROW #2, BOOKS #3	C. LOPTEN	1805	Y			SILVER END
626	SHORT GROUND SHELL CASING	RP 9mm N END OF BOOK ROW #2, JEG 2	C. LOPTEN	1809	Y			
627	SHELL CASING	RP 9mm UNDER SEAMS TABLE 3	C. LOPTEN	1808	Y			
628	SHELL CASING	RP 9mm UNDER SEAMS TABLE 3	C. LOPTEN	1807	Y			
629	LENS FRAG	BETWEEN FRONT DOOR	C. LOPTEN	1730	Y			
630	ROUND COPPER LENS FRAG	CORN OF TABLE #2	C. LOPTEN	1624	Y			
631	"	MIDDLEWAY GET. TABLE 1 & 3	C. LOPTEN	1759	Y			
632	EYEGASSES	UNDER TABLE #1	C. LOPTEN	1802	Y			Bloody
633	LENS FRAG	4' W OF TABLE #3	C. LOPTEN	1806	Y			
634	ROUND LENS COPPER FRAG #2	UNDER TABLE 2	C. LOPTEN	1653	Y			
635	"	"	C. LOPTEN	1655	Y			
636	"	S' END OF TABLE #2	C. LOPTEN	1722	Y			
637	"	NORTH END UNDER TABLE 2	C. LOPTEN	1812	Y			
638	SHORT GROUND CASING	"	C. LOPTEN	1813	Y			
639	"	NEXT TO TABLE 4	C. LOPTEN	1814	Y			

TEAM (D) 640-660 EVIDENCE RECOVERY LOG TEAM 1

LOCATION L1 BRARY
 DATE 042199

ASSIGNED PERSONNEL
GOETZ
RITTER
SOLARS

CASE REPORT NUMBER 99-1625
 EVIDENCE INVESTIGATOR LOPTEIN

LOPTEIN
SAVARY

#647 SKIPPED - SEE BOTTOM
~~648~~ ~~649~~ ~~650~~ ~~651~~ ~~652~~ ~~653~~ ~~654~~ ~~655~~ ~~656~~ ~~657~~ ~~658~~ ~~659~~ ~~660~~

4-21-99

ITEM #	DESCRIPTION	WHERE FOUND	RECOVERED BY	DATE/TIME RECOVERED	PHOTO	SUBLIST? Y/N	PACKAGING METHOD	MISC. COMMENTS
640	CORREA FRAG	6' EAST OF TABLE #2	C. LOPTEIN	4-21-1723	✓			
641	BULLET CASING RO 9mm LUGER	SOUTH END BAR BOOK ROOM 2-3	C. LOPTEIN	4-21-1810	✓			
642	SHOTGUN CASING	2' NE OF TABLE 6 CORREA (W/6)	C. LOPTEIN	4-21-1816	✓			PRIMUM - FLOOR TIM
643	PLASTIC WOODS	HALL, ROOM 2	C. LOPTEIN	4-21-1745	✓			
644	CORREA FRAG	UNDER TABLE #1	C. LOPTEIN	4-21-1804	✓			
645	" "	UNDER TABLE #4	C. LOPTEIN	4-21-1815	✓			(RECAL)
646	BULLET	6' S. OF TABLE 6	C. LOPTEIN	4-21-1948	✓			
648	BULLET SACKET	7' S. OF TABLE 6	C. LOPTEIN	4-22-1035	✓			
649	SHIRT CASING	7' SW " "	C. LOPTEIN	4-22-1036	✓			RO 9mm LUGER
650	CORREA LENO FRAG PAPER W/RO + CORREA LENO FRAG	8' " " " BOOKSHELF, LOWER SHELF	C. LOPTEIN	4-22-1037	✓			
651	LENO FRAG	W/FRT. OF FLOOR # 651	C. LOPTEIN	4-21-1948	✓			
652	CORREA LENO FRAG	11' S. OF BOOY 3 W/ID DEF. DOOR 3	C. LOPTEIN	4-21-1947	✓			
653	LENO FRAG	1' EAST 3' FROM BOOY 3 HALL	C. LOPTEIN	4-21-1945	✓			
654	CORREA LENO FRAGS X2	UNDER SPACE NEXT TO E WALL BOOKSHELF	C. LOPTEIN	4-21-1946	✓			
655	LENO FRAGS X2	8' S. OF TABLE 5 MIDDLE OF ROOM	C. LOPTEIN	4-22-1033	✓			
656	BULLET	2' S. OF TABLE 5	C. LOPTEIN	4-22-1039	✓			FEDERAL II 64 CALIBER 2 1/4 TO 2 1/2 W/ID DEF. DOOR 3 3' FROM BOOY 3
657	SHOTGUN SHELL	W/ID DEF. DOOR 2	C. LOPTEIN	4-22-1042	✓			
659	" "	W/ID DEF. DOOR 2	C. LOPTEIN	4-22-1042	✓			
660	CORREA FRAGS, 2 FRAGS	W/ID DEF. DOOR 2	C. LOPTEIN	4-22-1042	✓			

661-680

EVIDENCE RECOVERY LOG Team 1

LOCATION LABRARY
 DATE 042199
 CASE REPORT NUMBER 99-7625
 EVIDENCE INVESTIGATOR LOPTIEN

ASSIGNED GOETZ
 PERSONNEL RITTER
SOLIER
LOPTIEN
SLAVELY

*DIAGRAM ON BACK

ITEM #	DESCRIPTION	WHERE FOUND	RECOVERED BY	DATE/TIME RECOVERED	PHOTO	SUBLIST? Y/N	PACKAGING METHOD	MISC. COMMENTS
660	CARTRIDGE	E. JOE TABLE 5	C. LOPTIEN	4-22 1044	✓			PVC 9mm "LIVE ROUND"
662	LEAD FRAG	BEHIND TABLE 6 FLOOR UNDER CHAIR & OF TABLE 6	C. LOPTIEN	4-22 1046	✓			
663	CARBONES AND NOT-PIECE OF LEAD FRAG FOR	BEHIND TABLE 6 FLOOR UNDER CHAIR & OF TABLE 6	C. LOPTIEN	4-22 1048	✓			
664	LEAD FRAG	" " " TO REAR OF CHAIR FLOOR REAR-RT S. WALL 4' FROM ... ON TABLES, NE BY CHAIR	C. LOPTIEN	4-22 1114	✓			
665	LEAD FRAG	" " " TO REAR OF CHAIR FLOOR REAR-RT S. WALL 4' FROM ... ON TABLES, NE BY CHAIR	C. LOPTIEN	4-22 1116	✓			EAST CORNER of Room RIPPER LUGER LIVE ROUND
666	BULLET CASING	" " " TO REAR OF CHAIR FLOOR REAR-RT S. WALL 4' FROM ... ON TABLES, NE BY CHAIR	C. LOPTIEN	4-22 1117	✓			
667	CARTRIDGE	" " " TO REAR OF CHAIR FLOOR REAR-RT S. WALL 4' FROM ... ON TABLES, NE BY CHAIR	C. LOPTIEN	4-21 1952	✓			
668	METAL FRAGS LEAD LEAD (ROUND) BRASS	TABLE 5, REAR, NORTH EDGE	C. LOPTIEN	4-21 1952	✓			
669	" "	TABLE 5, REAR, NORTH EDGE	C. LOPTIEN	4-21 1952	✓			
670	LEATHERBOUND BOOK	TABLE 5, REAR, NORTH EDGE	C. LOPTIEN	4-21 2026	✓			BLOODY FINGERPRINTS
671	SHELL CASING	TABLE 5, REAR, NORTH EDGE	C. LOPTIEN	4-21 2027	✓			"CFL LUGER"
672	" "	" " " TO REAR OF CHAIR FLOOR REAR-RT S. WALL 4' FROM ... ON TABLES, NE BY CHAIR	C. LOPTIEN	4-21 2028	✓			
673	BULLET	" " " TO REAR OF CHAIR FLOOR REAR-RT S. WALL 4' FROM ... ON TABLES, NE BY CHAIR	C. LOPTIEN	4-21 2028	✓			
674	BRASS MAGAZINE (EMPTY)	" " " TO REAR OF CHAIR FLOOR REAR-RT S. WALL 4' FROM ... ON TABLES, NE BY CHAIR	C. LOPTIEN	4-21 2047	✓			
675	BULLET CASING	" " " TO REAR OF CHAIR FLOOR REAR-RT S. WALL 4' FROM ... ON TABLES, NE BY CHAIR	C. LOPTIEN	4-21 2047	✓			
676	LEAD FRAG	" " " TO REAR OF CHAIR FLOOR REAR-RT S. WALL 4' FROM ... ON TABLES, NE BY CHAIR	C. LOPTIEN	4-22 1126	✓			
677	LEAD FRAG	" " " TO REAR OF CHAIR FLOOR REAR-RT S. WALL 4' FROM ... ON TABLES, NE BY CHAIR	C. LOPTIEN	4-22 1127	✓			
678	" "	" " " TO REAR OF CHAIR FLOOR REAR-RT S. WALL 4' FROM ... ON TABLES, NE BY CHAIR	C. LOPTIEN	4-22 1128	✓			
679	STEEL SHELL	" " " TO REAR OF CHAIR FLOOR REAR-RT S. WALL 4' FROM ... ON TABLES, NE BY CHAIR	C. LOPTIEN	4-23 0951	✓			
680	LEAD FRAGMENT	" " " TO REAR OF CHAIR FLOOR REAR-RT S. WALL 4' FROM ... ON TABLES, NE BY CHAIR	C. LOPTIEN	4-23 0951	✓			

LOCATION LIBRARY

DATE 042199

CASE REPORT NUMBER 99-1625

EVIDENCE INVESTIGATOR LOPTIEN

681-698 @ 702

EVIDENCE

RECOVERY LOG

PAGE 5

ASSIGNED PERSONNEL
GOERTZ
RITTER
SOLARI

LOPTIEN
SAWVELL

4-21-99

ITEM #	DESCRIPTION	WHERE FOUND	RECOVERED BY	DATE/TIME RECOVERED	PHOTO	SUBLIST? Y/N	PACKAGING METHOD	MISC. COMMENTS
681	METAL FRAG	D. SIAE ROOM #4 ON FLOOR	C. LOPTIEN	4-21 2050	✓			
682	METAL FRAG X2	" "	C. LOPTIEN	4-21 2051	✓			BLOOD
683	PLASTIC WOODING	TABLE 3, WEST SIDE FLOOR, MISSOURY	C. LOPTIEN	4-22 2299 1119	✓			
684	PLASTIC WOODING	TABLE 3 WEST SIDE FLOOR SECTORS JUNE 2, 1992, N. ROOM 2, SEC. 2, N.	C. LOPTIEN	4-22 1120	✓			UNDERMANT ID
685	METAL FRAG	TABLE 6, ON BOOK SE CORNER	C. LOPTIEN	4-22 1122	✓			CHAIR ID
686	METAL FRAG	6" W. TABLE ON FLOOR SW	C. LOPTIEN	4-22 1125	✓			BOOK CASE
687	" "	TABLE 1 / CHAIR ID	C. LOPTIEN	4-22 1124	✓			
688	CASING	TAKEN BY T. ADAM ON 04-21-99	C. LOPTIEN	4-22 1647	✓			FROM TADAM TO C. LOPTIEN
689	METAL FRAGMENT	TABLE 3 UNDER CHAIR 3B	C. LOPTIEN	4-23 0856	✓			
690	METAL FRAGMENT	TOP OF ISLAND 1 SW CORNER	C. LOPTIEN	4-23 0859	✓			
691	M/M 9mm LUGER LIVE CARTRIDGE	BEHIND STAFF SERVICE AREA ON FLOOR	C. LOPTIEN	4-23 1055	✓			SEE SIDC
692	METAL FRAGMENT	BEHIND STAFF SERVICE AREA ON FLOOR	C. LOPTIEN	4-23 1058	✓			NW SIDE
693	PULVIC SHOTGUN WOODING	STAFF SERVICE AREA ON FLOOR	C. LOPTIEN	4-23 1100	✓			SW AREA
694	PLASTIC SHOTGUN WOODING	" "	C. LOPTIEN	4-23 1101	✓			NW AREA
695	PAPER SHOTGUN WOODING	" "	C. LOPTIEN	4-23 1103	✓			NW AREA
696	Metal FRAGMENT	" "	C. LOPTIEN	4-23 1104	✓			NW AREA
697	PAPER SHOTGUN WOODING	" "	C. LOPTIEN	4-23 1105	✓			NW AREA
698	Metal FRAGMENT	STAFF SERVICE AREA ON CORNER	C. LOPTIEN	4 1108	✓			SW FRONT CORNER

EVIDENCE RECOVERY LOG

LOCATION Garage
 DATE 04-23-99 (note piece out)

CASE REPORT NUMBER 99-7625
 EVIDENCE INVESTIGATOR LOPTEN

ASSIGNED PERSONNEL
 GOETZ NOAK
 PATER LOPTEN
 SOLANS

ITEM #	DESCRIPTION	WHERE FOUND	RECOVERED BY	DATE/TIME RECOVERED	PHOTO	SUBLIST? Y/N	PACKAGING METHOD	MISC. COMMENTS
699	Metal Fragment	INSIDE LOWER TRAY ON PRINTER	C. LOPTEN	04-23-99 1110	✓			
700	Metal Fragment	ON PAPERS IN BAGGIE NEXT TO THE PRINTER ON SERVICE CENTER DESK #1	C. LOPTEN	04-23 1112	✓			Need computer by GARDNER TRACKS
701	PAPER SHOTGUN WADING		C. LOPTEN	04-23 1114	✓			
702	SEE SHEET #5							
703	BLOOD STAIN UNDER TABLE #1	UNDER TABLE #1 CARPET	C. LOPTEN	04-23 1005 AM	✓		CUT CARPETTING	BLOOD
704	BLOOD STAIN ON TABLE	TOP OF TABLE #6	C. LOPTEN	04-23 1008 AM	✓		SCAFFE INTO CONTAINER	BLOOD
705	BLOOD STAIN ON TABLE	TOP OF TABLE #5	C. LOPTEN	04-23 1011 AM	✓		"	BLOOD
706	BLOOD STAIN ON FLOOR	NEXT TO CHAIR #2A	C. LOPTEN	04-23 1016 AM	✓		CUT CARPETTING	"
707	BLOOD STAIN ON CARPET	NEXT TO TABLE #2 NE CORNER	C. LOPTEN	04-23 1028 AM	✓		CUT CARPETTING	"
708	BLOOD STAIN ON CARPET	NEXT TO TABLE #2 SW CORNER	C. LOPTEN	04-23 1031 AM	✓		CUT CARPETTING	"
709	BLOOD STAIN ON CARPET	CARPET BETWEEN ROW #2 & #3	C. LOPTEN	04-23 1038 AM	✓		CUT CARPETTING	"
710	BLOOD STAIN ON BOOK-CASE	ROW #4	C. LOPTEN	04-23 1142 AM	✓		Tape LIFT	"
711	BLOOD STAIN POOL (V-3)	POOL (V-3)	C. LOPTEN	04-23 1145 AM	✓		CUT CARPETTING	"
712	BLOOD STAIN POOL (V-2)	POOL (V-2)	C. LOPTEN	04-23 1147 AM	✓		CUT CARPETTING	"
713	BLOOD STAIN POOL (V-1)	POOL (V-1)	C. LOPTEN	04-23 1150 AM	✓		"	"
714	BLOOD STAIN POOL (V-5)	POOL (V-5)	C. LOPTEN	04-23 1153 AM	✓		"	"
715	BLOOD STAIN POOL (V-4)	POOL (V-4)	C. LOPTEN	04-23 1215 AM	✓		"	"
716	BLOOD STAIN ON CARPET	UNDER TABLE #2 SW CORNER	C. LOPTEN		✓		"	"
717	BLOOD STAIN ON CARPET	UNDER TABLE #2 EAST SIDE	C. LOPTEN		✓		"	"
718	BLOOD STAIN ON TABLE #1	SIDE OF TABLE #1	C. LOPTEN	04-23 1218 AM	✓		SCAPING	"

LOCATION CLIFDRARY

DATE 04-23-94

CASE REPORT NUMBER 99-7625

EVIDENCE INVESTIGATOR LOPTIEN

ASSIGNED

PERSONNEL GOETZ ADMIR

RITZER LOPTIEN

SOLAKS

PAGE 1

ITEM #	DESCRIPTION	WHERE FOUND	RECOVERED BY	DATE/TIME RECOVERED	PHOTO	SUBLIST? Y/N	PACKAGING METHOD	MISC. COMMENTS
719	METAL FRAGMENT	BEHIND BOOKSHELF #1-ROW	C. LOPTIEN	4-23 1501 hrs	✓			
720	SHOTGUN SHELL 000 15 PELLETS	TRANSDUCER NE BY FRONT ENTRANCE	C. LOPTIEN	4-23 1158 hrs	✓			LIBRARY 311/76 mm
721	BLACK & YELLOW ENVELOPE BACKPACK w/CONTENTS		C. LOPTIEN	4-23 1348 hrs	✓			
722	COLOR MOUNTAIN BOOK, SILVER W/RED LETTERS, RED TABS	UNDER TABLE #2	C. LOPTIEN	4-23 1350 hrs	✓			BOOK OPEN 218-219
723	BLUE LEATHER PURSE	UNDER TABLE #4	C. LOPTIEN	4-23 1352 hrs	✓			(V-2)
724	GREEN TRANSPARENT BACKPACK w/CONTENTS	TABLE #4	C. LOPTIEN	4-23 1353 hrs	✓			(V-2)
725	ACCEPTA BOOK & NOTEBOOK & PAPER	TABLE #4	C. LOPTIEN	4-23 1354 hrs	✓			(V-2)
726	BLUE STAPLING BACKPACK w/CONTENTS	TABLE #6	C. LOPTIEN	4-23 1357 hrs	✓			(V-3)
727	MATH & CALCULATOR	TABLE #6	C. LOPTIEN	4-23 1358 hrs	✓			(V-3)
728	CHEVY TRUCK HAT	TABLE #6	C. LOPTIEN	4-23 1359 hrs	✓			(V-3)
729	RED BACKPACK w/CONTENTS	UNDER TABLE #4 CUT OFF VESTIBULAR TO CHAIR #78	C. LOPTIEN	4-23 1409 hrs	✓			(V-4) BLOODY
730	BLUE JANSFON BACKPACK w/CONTENTS	TABLE #9	C. LOPTIEN	4-23 1411 hrs	✓			(V-5)
731	SOLWFELD BOOK	TABLE #9	C. LOPTIEN	4-23 1412 hrs	✓			(V-5)
732	COPPER LUMINOUS SPOT PELLET	STAFF SERVICE AREA UNDER HP-COUNTER	C. LOPTIEN	4-23 1443 hrs	✓			
733	LEAD FRAGMENT	" "	C. LOPTIEN	4-23 1458 hrs	✓			ENCLOSURE IN CABINET
734	LEAD FRAGMENT	" "	C. LOPTIEN	4-23 1459 hrs	✓			ENCLOSURE IN CABINET
735	PACKAGES OF PAPER w/ 3 sheets of pellets	" "	C. LOPTIEN	4-23 1417 hrs	✓			
736	MINOLTA SAT #101 RELEASER (ANISTERIC) PATT 6. 125	MONOLTA STATION	C. LOPTIEN	4-23 1601	✓		ASA SET AT 400	ON PRESENT #8 FILM ONLY
737	KODAK FILM	TABLE #10	C. LOPTIEN	4-23 1609	✓			16 FRAME TAPER 311/76 mm
738	STEEL w/ BEHIND SERVICE CENTER	BEHIND SERVICE CENTER THEN MOVED	C. LOPTIEN	4-23 1609	✓			NO EVIDENCE

COL. FELL

EVIDENCE RECOVERY LOG TEAM # 1

LOCATION LIBRARY
 DATE 04-26-99
 CASE REPORT NUMBER 99-7625
 EVIDENCE INVESTIGATOR LOPTIEN

ASSIGNED PERSONNEL
GOETZ ADAIR
RITTEL LOPTIEN
SOLAKS

ITEM #	DESCRIPTION	WHERE FOUND	RECOVERED BY	DATE/TIME RECOVERED	PHOTO	SUBLIST? Y/N	PACKAGING METHOD	MISC. COMMENTS
739	LEAD FRAGMENT	DANGER FACE OF QUINCE BLOW MACHETER	C. LOPTIEN	04-27 1501	✓			5746BDDC0
740	LEAD FRAGMENT	II	C. LOPTIEN	04-27 1505	✓			5746BDDC0
741	COPPER JACKET & FRAGMENT LEAD BULLET	WOOD CARPET FOOT BLOOD TOMLIN HEAD	C. LOPTIEN	04-26 1406	✓			5746BDDC0 / Buss & white Fluorid chaise
742	Casings R-P 9mm Luger	Under the ^{the} chair ^{chair} in Lib. Section of Area (Chair in Lib.)	C. LOPTIEN	04-26 1411	✓			"
743	LEAD FRAGMENT	Area behind	C. LOPTIEN	04-26 1412	✓			"
744	LEAD FRAGMENT	Under South Wall	C. LOPTIEN	04-26 1415	✓			
745	COPPER JACKET BULLET in wall	In wall behind	C. LOPTIEN	04-26 1418	✓			
746	BULLET in wall	In wall above window 3rd floor	C. LOPTIEN	04-26 1418	✓			
747	COPPER JACKET Piece THRU	FLOOR in office	C. LOPTIEN	04-26 1853	✓			
748	COPPER JACKET Piece	ON COFFEE TABLE IN OFFICE TWO	C. LOPTIEN	04-26 1854	✓			
749	LEAD FRAGMENT FROM OFFICE #2	LOBBY FLOOR OFFICE #2	C. LOPTIEN	04-26 1854	✓			
750	Piece of copper Fragment	FLOOR UNDER CHAIR C' OFFICE 2	C. LOPTIEN	04-26 1855	✓			
751	Fragment in back of chair 'A'	Chair in office 2	C. LOPTIEN	Not collected	✓			No evidence
752	LEAD FRAGMENT in wall	South wall office 2	C. LOPTIEN	04-26 1855	✓			
753	Piece of lead Fragment	Back of chair 'A' office 2	C. LOPTIEN	04-26 1854	✓			
754	Piece of lead Fragment in foam	Foam, chair 'E' office 2	C. LOPTIEN	04-26 1857	✓			
765	Copper & lead bullet on floor	FLOOR UNDER TV. HALLWAY	C. LOPTIEN	04-26 1859	✓			
756	Copper & lead bullet # 756S	II	C. LOPTIEN	No evidence	✓			#756 (not in TV. AS 1st PROGRESS)
757	Copper & lead bullet in mud DRAWN #10 FROM TV.	MUD DRAWN #10 FROM TV. TOP - COOSED IN STAIR WOOD DRAWER #3 FROM TOP - BACK OF DRAWER	C. LOPTIEN	04-26 1900	✓			
758	COPPER 40 BULLET		C. LOPTIEN	04-26 1900	✓			

15 this
 photographed?

LOCATION LIBRARY
 DATE 04-26-99
 CASE REPORT NUMBER 99-1625
 EVIDENCE INVESTIGATOR LOPTEN

ITEM #	DESCRIPTION	WHERE FOUND	RECOVERED BY	DATE/TIME RECOVERED	PHOTO	SUBLIST? Y/N	PACKAGING METHOD	MISC. COMMENTS
759	COPPER & LEAD FRAGMENT FROM CASEL #1	Metal Fragments of CASEL #1	C. LOPTEN	04-26 1901	✓			
760	Metal Fragments	IN PICTURE FRAME	C. LOPTEN	04-26 1901	✓			BH-1 - Fragment Team # 2 No Copper Jacket
761	LEAD BULLET FRAGMENT	LMCS BH-1 N/CASEL (G) wall	C. LOPTEN	04-26 1902	✓			
762	LEAD FRAGMENT	8th & LMCS-5 BH-3 & BH-5 unit	C. LOPTEN	04-26 1903	✓			
763	COPPER & LEAD BULLET	IMPACT BY LMCS	C. LOPTEN	04-26 1902	✓			
764	COPPER & LEAD BULLET	FLOOR - ENTRANCE LMCS	C. LOPTEN	04-26 1903	✓			BH-1 LMCS
765	LEAD FRAGMENT	FLOOR - LMCS	C. LOPTEN	04-26 1903	✓			
766	COPPER JACKET	wall (SOUTH) LMCS	C. LOPTEN	04-26 1904	✓			BH-7 & BH-2 LMCS
767	Two (2) COPPER JACKET & LEAD PIECE	wall (SOUTH) LMCS	C. LOPTEN	04-26 1904	✓			BH-3, BH-4, BH-10 LMCS
768	COPPER JACKET	IN CEILING	C. LOPTEN	04-26 1904	✓			
769	BLOODSTAIN ON CARPET	FLOOR IN HALLWAY	C. LOPTEN	04-26 1906	✓		CUT CARPET	
770	BLOODSTAIN ON WALL	wall BY (N) ENTRANCE TO HALLWAY	C. LOPTEN	04-26 1906	✓		TAPELIFT	
771	BLOODSTAIN ABOVE PANIC BAR	ABOVE PANIC HALL (N) ENTRANCE HALLWAY	C. LOPTEN	04-26 1906	✓		TAPELIFT	
772	BLACK RESIDUE ON CARPET	Ⓢ Near ENTRANCE (N) HALLWAY	C. LOPTEN	04-26 1914	✓		CUT CARPET	
773	LEAD BULLET/SHOT	LIBRARY EAST WALL	C. LOPTEN	04-27 0933	✓			
774	LEAD BULLET/SHOT	LIBRARY TABLE B2 LEG ENTRANCE	C. LOPTEN	04-27 0937	✓			
775	BLOOD MATRIN	ROW'S EAST SIDE THIRD SHELF IN ROW'S 2 WEST SIDE	C. LOPTEN	04-28 0908	✓		3 books collected	Blood
776	Blood smears on books	TOP SHELF ROW 3 EAST SIDE	C. LOPTEN	04-27 1623	✓		Tapelift on	Blood
777	Plastic woodpin	HEAT TO ROW 3 FLOOR EAST SIDE	C. LOPTEN	04-27 1624	✓			
778	COPPER FRAGMENT & LEAD	HEAT TO ROW 3 FLOOR EAST SIDE	C. LOPTEN	04 1625	✓			

LOCATION Library

DATE 04-26-99

CASE REPORT NUMBER 99-7625

EVIDENCE INVESTIGATOR LOPTIEN

ASSIGNED GOETZ ADAIR
PERSONNEL RATNER LOPTIEN
SOLAS

ITEM #	DESCRIPTION	WHERE FOUND	RECOVERED BY	DATE/TIME RECOVERED	PHOTO	SUBLIST? Y/N	PACKAGING METHOD	MISC. COMMENTS
779	COPPER FRAGMENT	FLOOR BETWEEN ROW #3 & ROW #4	C. LOPTIEN	04-27 1626 hr	✓			
780	NO EVIDENCE							NO EVIDENCE
781	LEAD PELLET	UNDER TABLE #1	C. LOPTIEN	04-28 0747	✓			EMBEDDED IN CROSS SUPPORT
782	BLOOD ON CLOTH OF CHAIR	CHAIR 10H ON LEFT OF SEATBACK	C. LOPTIEN	04-28 0751	✓		CUT CLOTH	
783	BLOOD ON CLOTH OF CHAIR	CHAIR 9D ON CLOTH OF SEATBACK OR CHAIR SEAT # 9D	C. LOPTIEN	04-28 0756	✓		CUT CLOTH	
784	LEAD FRAGMENT	ON CHAIR BY TABLE 2 & COPPER WIRE	C. LOPTIEN	04-28 0801	✓			
785	COPPER/LEAD SHOT PELLET	ROW 3, 1ST LEFT PARTIC SHOTGUN	C. LOPTIEN	04-28 0807	✓		Tape Lift	
786	POSSIBLE BLOODSTAIN	ROW #1 BETWEEN SHOE & SEAT W/ ROW #1, FLOOR, SEAT END	C. LOPTIEN	04-28 0819	✓			#1 (S)
787	LEAD FRAGMENT	ROW #1 FLOOR, SEAT END	C. LOPTIEN	04-28 0821	✓			#1
788	LEAD FRAGMENT	ROW #1 FLOOR, SEAT END	C. LOPTIEN	04-28 0822	✓			#3
789	R-P GUN SHOT CASING	ROW #1 WALL, JOINT	C. LOPTIEN	04-28 0824	✓			#4
790	COPPER FRAGMENT ON WALL	ROW #1 FLOOR, SEAT END	C. LOPTIEN	04-28 0830	✓			#5
791	COPPER & LEAD FRAGMENT	ROW #1 FLOOR, SEAT END	C. LOPTIEN	04-28 0831	✓			#12
792	LEAD FRAGMENT	ROW #1 FLOOR, SEAT END	C. LOPTIEN	04-28 0832	✓			#13 (N)
793	LEAD SHOT PELLET	SEAVIC CENTER TRAIL DOOR - WEST END	C. LOPTIEN	04-27 1621	✓			EMBEDDED IN DOOR
794	LEAD/COPPER SHOT PELLET	SEAVIC CENTER TRAIL DOOR - WEST END	C. LOPTIEN	04-27 1620	✓			
795	LEAD/COPPER SHOT PELLET	SEAVIC CENTER TRAIL DOOR - WEST END	C. LOPTIEN	04-27 1646	✓			
796	LEAD/COPPER SHOT PELLET	SEAVIC CENTER TRAIL DOOR - WEST END	C. LOPTIEN		✓			
797	LEAD/COPPER SHOT PELLET	SEAVIC CENTER TRAIL DOOR - WEST END	C. LOPTIEN		✓			
798	COPPER COATED PELLET	INSIDE POWER AREA	C. LOPTIEN		✓			

EVIDENCE RECOVERY LOG

PAGE 11

LOCATION LIBRARY

DATE 04-26-99

CASE REPORT NUMBER 99-7625

EVIDENCE INVESTIGATOR LOPTIEN

ASSIGNED PERSONNEL

GOETZ

ADAIR

RITEN

LOPTIEN

SOLAKS

ITEM #	DESCRIPTION	WHERE FOUND	RECOVERED BY	DATE/TIME RECOVERED	PHOTO	SUBLIST# V/N	PACKAGING METHOD	MISC. COMMENTS
799	LEAD COATED PELLET	INSIDE ARMED AREA WEST END	C. LOPTIEN	04-27 1648	✓			
800	COPPER COATED PELLET	INSIDE POWER AREA	C. LOPTIEN	04-27 1650	✓			
801	COPPER JACKET	SHELF BEHIND SERVICE COUNTER	C. LOPTIEN	04-28 0933	✓			
802	LEAD FRAGMENT	FLOOR UNDER JOE	C. LOPTIEN	04-28 0935	✓			
803	COPPER LEAD SHOT PELLET	IN TAP ON SERVICE COUNTER	C. LOPTIEN	04-28 1009	✓			
804	PIECE OF COPPER JACKET	WALL BEHIND #2 EMBEDDED IN WALL	C. LOPTIEN	04-28 1105	✓			
805	71 Polaroid Photographs	TAKEN BY ADAIR	C. LOPTIEN	04-28 1545				C.O.C. - T. ADAIR m 15:51 PM 4-28-99
806	2 ATTENDANCE TAGS/STICKERS	FRONT COUNTER ATTENDANCE DESK	C. LOPTIEN	04-29 1446	NO PHOTO			5 T. ADAIR 4-28-99
807	7 Polaroids	TAKEN BY ADAIR	C. LOPTIEN	04-29 1630				NO C. T. ADAIR m 10:53 4-29-99
808	6 Polaroids	TAKEN BY RITEN	C. LOPTIEN	04-20 1100				T. ADAIR 5:18

(R3)

ALSO 99-16215
JCSO 99-7625

Revision notes per
Tom Adair 11/5/99

copied from plot
submitted to CBI
Lynn A. DeLong 9719

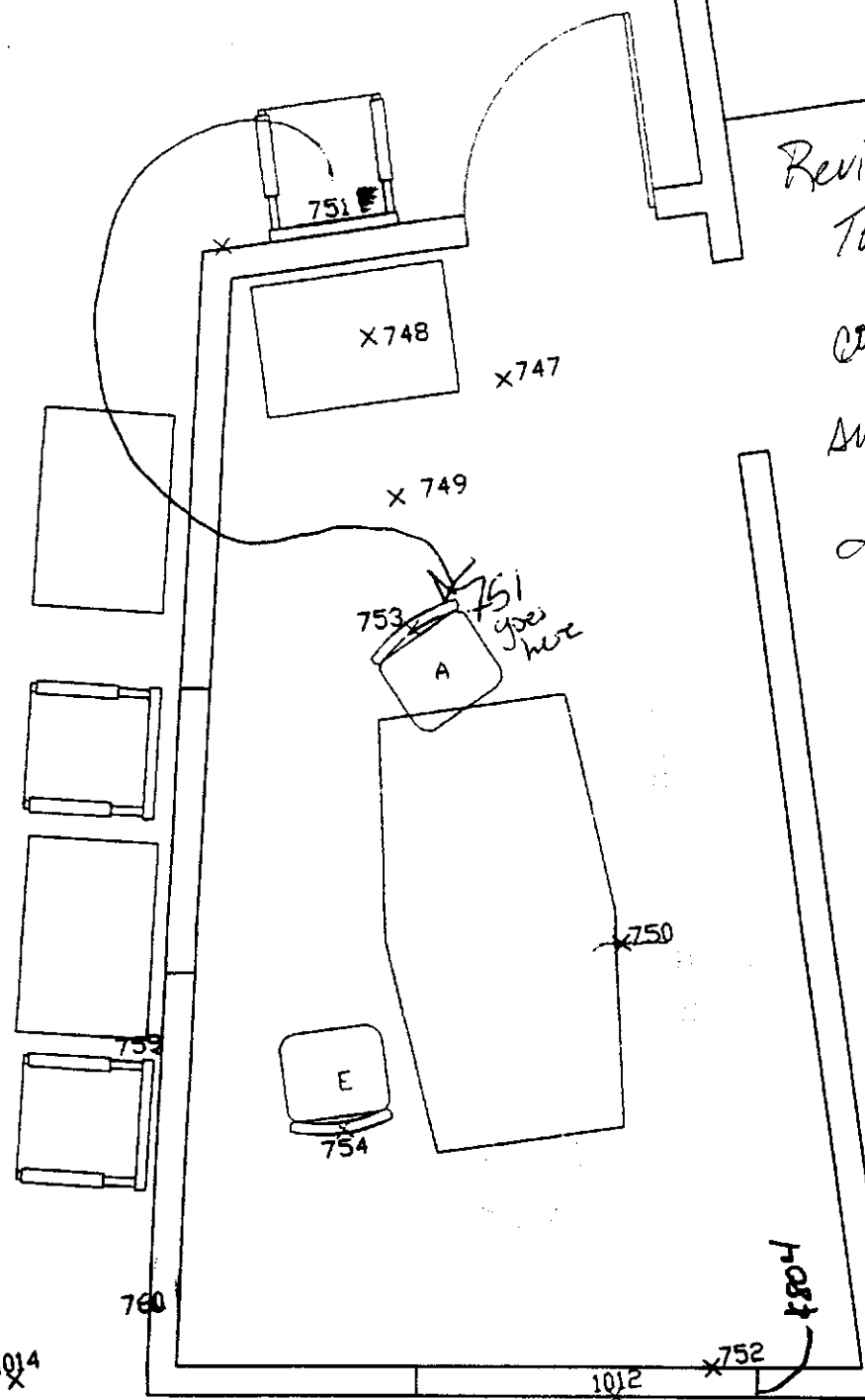

LIGHT
SHEETS

1014

LIBRARY
HEIGHT
INCHES

WINDOWS

AT
SHEETS

BOOK CART 30X17 X36	1057 MICROFICHE TABLE X X 1011 1013 60X30X29
------------------------------	---

	1152
--	------

14 210
Jan 9719
11/15/97

✓ 603 - W side trophy case (move) 1ft west + 1'9" N of W side trophy case (R P 9 on case)

✓ 658 - duplicate by entry ~~no~~ removed from door ~~area~~

✓ 659 - dup by entry close to T5

coord specified

✓ 660 - ^{moved} off table edge below T9 - T6. From base: 1'0", 5'1" ~~1'0" - 5'1" from wall~~

✓ 677 - move by B3, corner of T6. Ref: 15'3"/5'8" lead frag maybe from wall instead of R. SE 12' - 3" SE corner

✓ 683 - delete (dup) by T5. S10 T3 west side. Ref Man: 732 - 17 main base (guarding)

✓ 695 - move to positive side of base line (north) (photo T1-11-7)

✓ 696 - move north of baseline SSA / + 20 47'0"/8" built in bookcase

~~✓ 697~~ - move north of baseline SSA / + 20 45'7"/11'0"

✓ 709 - by R3C ok remove? Remove the "?" door

✓ 729 - on floor T14 change to floor layer backpack cut off victim

✓ 730 - move to floor T9, N of table

~~730~~ on floor 735, 740 add "0" for approx. Shotgun pattern in back

✓ 738 - chair on check out counter (bullet impact site) add # exact spot?

✓ 751 - elevated in chair, next to 753 (wrong chair) conf SW chair back No exit chair A ✓

✓ 752 - duplicate of 804 - use both numbers lead frag in wall (804 on copper floor) elevated? for in wall

✓ 757 - other end of cabinet South end

✓ 758 - other end of cabinet 761h added to LMC 5/4, moved in LMC 3

✓ 762 - move closer to door with 763 in wall between LMC 3/4 E of knob pad

✓ 763 - (add) in SW wall between LMC 3/LMC 4

~~763 in south wall~~

✓ 765 - in SW corner, not NW corner LMC 5 11" N of SW door, 11" E of W wall

766 - in south wall

✓ 680 - change layer to elevated Tom needs to provide (T14/B4)

✓ Chair at N end R1 rotated in slightly per photo view

Revisions to Team 1, East side of Library

99-16215
Jan 9 119
11/15/99

add ~~#~~ ~~20~~
move #15
change legs 4
add to 3 dup

✓ 0 add 775 R3c

767 - in south wall see location

✓ 768 - ~~change to elevated~~ ^{already on ceiling} ^{layer} near R4, B4, T 14

✓ 776 - (add) elevated, R2B, NW corner, blood

✓ 777 - SGW on floor SE corner R3c room 700

○ 779 - (add) W of R3c (photo T1-15-10) North end corner

✓ 781 - (add) TL impact marks on center support of table. lead pellet exact location?

~~784 - elevated~~

○ 784 - elevated on chair chair 92 change X layer location not specific - no X made

✓ 785 - (add) on chair lead frag (photo T1-16-8) Near R1 non-specific spot

✓ 786 - (add) R3A NE corner, elevated blood - non-specific

✓ 796 - elevated ^{move around corner} ^{can't take of} " ? " slab on panel below R1 T1-17-7

797 - ^{pellets} inside panel below 803

798 - "

799 - "

800 - inside panel below 803 - into pillar, but below counter top level

✓ 801 - (add) elevated back book case - frag. ^{copied jacket} ^{E end section ph removed}

✓ 803 - video, elevated

✓ 804 - copper jacket embedded in wall (752)

need more precise locations for items in Row 1; Adair to provide add'l sketch copies

✓ add baseline along R1

X 787 - on so wall, 1 in w of R1 LISTED AS "NO EVIDENCE" on log

✓ 788 - 9" fr so wall, 11 in w of R1 (not added)

✓ 789 - 2³ fr so, 1 ft. from E wall

✓ 790 in wall, 8" fr so, height 12

2 791 - 2 frags (copper lead) 93 + 93 fr so wall

(719 @ 9", +08)

✓ 792 - 93 fr so, 1 1/2 fr R1

✓ 793 - 14 1/2 fr so, 8 in fr E wall

✓ 794 - copper paint 34 1/2 fr so, 9 in fr wall

✓ 795 - copper pellet 37 fr so, 11.5 in fr wall

Team One

of projectiles, casing, shotgun shells, wadding and live rounds

9mm casings: 19 total

Live 9mm cartridges: 3 total

Spent shotgun shells: 9 total

Shotgun wadding: 16 total

Miscellaneous projectiles: 114 total

(** These numbers in respect to shotgun wadding and projectiles are approximate numbers. Many of the packages may have contained more than one piece of copper jacket or lead fragments. These numbers reflect the number of packages that contain fragments.)

D99-1333
D

fax = (219) 542-6411

051199//0830
↓

BARRIE - T1

- 1) DOBs 4-5
- 2) names of injured & injuries
- 3) emergency hallway - when out & times
- 4) who shot into hallway - officers
- 5) staff service area - shot @ twice? no blood -
chairs picked up - TV what did she see?
- 6) what paramedics/body movers did on injured & bring all in lib
came for bomb people/SWAT
↳ DEPOSTER - moved backpack

list tables & those sitting there belongings

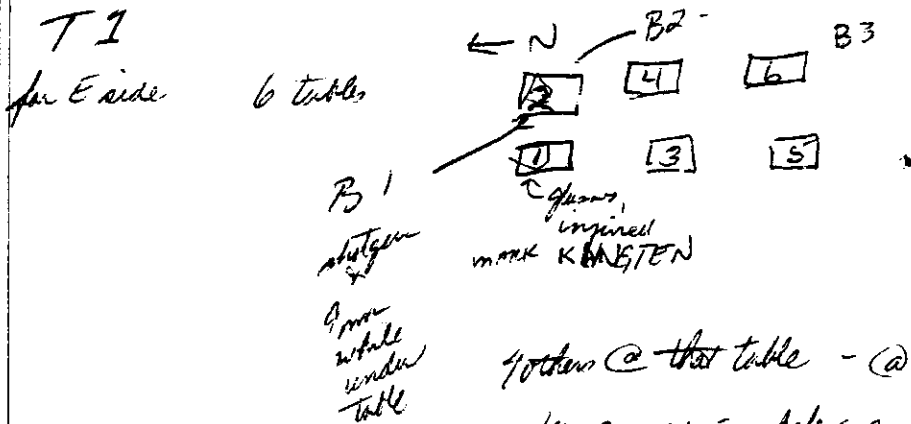

4000 @ that table - @ least 2 injured
VA SCOUR - belong on chair - so 6 people
under TABLE 2

B2 @ T4 then to tab 2

also table 1 - another person - also und

table 3 - no one injured / shot - 1 waitress under - other
belonging there 2 lines

tab 4 only one there B2 - shot by tab 2

tab 5 - live people

tab 6 - B3 shot @ thru chair - hole
then head shot 9mm - while on floor

tab 5 bloody leatherman tool

tab 6 possibly "aspirated" blood

middle area - 8 tables in middle

under tab 9 B #4
mauser orig. injured by tab 1 -
maybe sitting near KIRBY
goes thru the cases - back @ tab 9 -

1 shot thru chair - 9mm - may not be same as

1 shot while on chair - 9mm in nose, thru spine
floor "out" neck
fatal
under chair

tab 14 B #5 DEPOORR shot of 9mm possibly 2 diff directions
left flap at hand multiple - from S + E
bleep out

all way to N + on W side blood transfer on chairs - no holes

re-entrance from hall - orig. from landing to cafeteria - 9mm

stuff ect. @ least 2 shotgun blast from entry - 2 wps on one L on S wall
in NW section 14 rnds - thru glass windows + doorway - 10.45 and -
tray on higher
general outside
no blood seen - no ret. fire 9mm .40' .45' of 10.45 -
indicated